

R505EB8DA

TOP VIEW

ADA ACCESSIBILITY GUIDELINE - ADAAG CONFORMANCE

ELEVATED	ACCESSIBLE	RAMP ACCESSIBLE	GROUND	TYPES
11	11/6	0	8/4	3/3

R5

FOR KIDS
AGES
2-5

GENERAL NOTES:

This conceptual plan is based on information provided prior to construction. Detailed site information, including the following, should be obtained, evaluated, and utilized in the final project design. Exact site dimensions, topography, existing utilities, soil conditions and drainage solutions.

WARNING: Accessible safety surfacing material is required beneath and around this equipment that has a critical height value (Fall Height) appropriate for the highest accessible part of this equipment. Refer to the CPSC's Handbook For Public Playground Safety, Section 4: Surfacing.

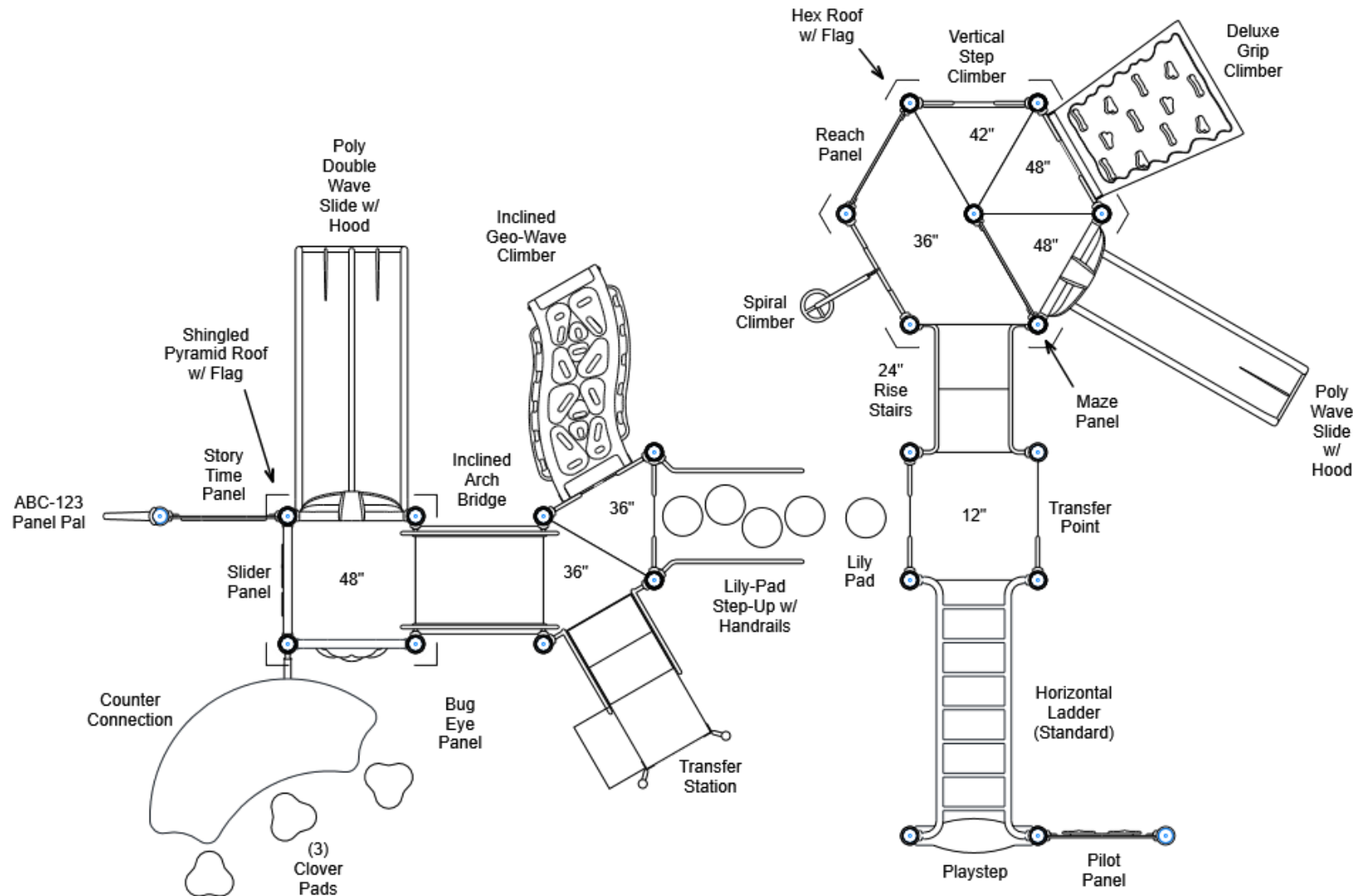

STRUCTURE#: R505EB8DA
PROJECT#: R505EB8DA
DATE: 8/17/2021

MIN. USE ZONE: 46' x 38'

PLAYCRAFT REP:
Playcraft Direct, Inc.

R505EB8DA SITE PLAN

ADA ACCESSIBILITY GUIDELINE - ADAAG CONFORMANCE

ELEVATED	ACCESSIBLE	RAMP ACCESSIBLE	GROUND	TYPES
11	11/6	0	8/4	3/3

R5

FOR KIDS
AGES
2-5

GENERAL NOTES:

This Preliminary Site Plan is based on measurements that were provided in the initial planning phase. All dimensions must be verified prior to the submission of a purchase order. Playcraft Systems will not be held responsible for any discrepancies between actual dimensions and dimensions submitted in the planning phase.

The Minimum Use Zone for a play structure is based on the product design at the time of proposal. Components and structure designs may be subject to change which may affect dimensions. Therefore, before preparing the site, we strongly recommend obtaining final drawings from the factory (available after the order is placed and included in the Assembly Manual).

WARNING: Accessible safety surfacing material is required beneath and around this equipment that has a critical height value (Fall Height) appropriate for the highest accessible part of this equipment. Refer to the CPSC'S Handbook For Public Playground Safety, Section 4: Surfacing.

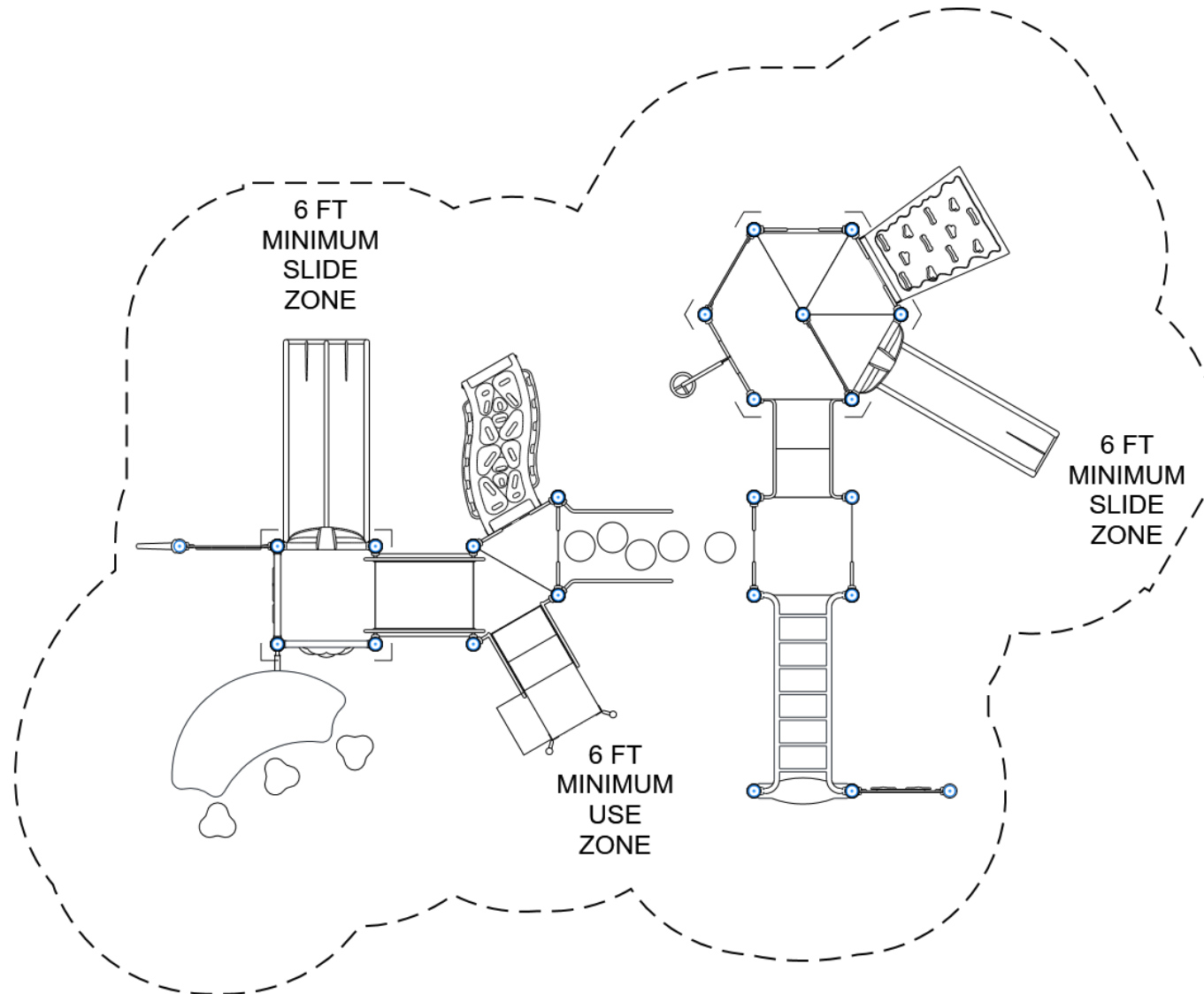

PROJECT#: R505EB8DA
DATE: 8/17/2021

MIN. USE ZONE: 46' x 38'

PLAYCRAFT REP:
Playcraft Direct, Inc.

R505EB8DA
SW VIEW

R5

FOR KIDS
AGES
2-5



STRUCTURE#: R505EB8DA
PROJECT#: R505EB8DA
DATE: 8/17/2021

R505EB8DA
NE VIEW

R5

FOR KIDS
AGES
2-5



STRUCTURE#: R505EB8DA
PROJECT#: R505EB8DA
DATE: 8/17/2021



Bill of Materials

R505EB8DA

Project# R505EB8DA

8/17/2021

Item	Description	Quantity
R505EB8DA		
HS-1004-R	Collars	70
GF-7002	Dome Cap, R5	13
S-1007-R5-07ft	Post, 07ft R5	2
S-1009-R5-09ft	Post, 09ft R5	6
S-1010-R5-10ft	Post, 10ft R5	4
S-1011-R5-11ft	Post, 11ft R5	1
S-1014-R5-14ft	Post, 14ft R5	10
S-1101-R5	Square Deck	2
S-1102-R5	Tri-Deck	5
S-1103-R5	Hex Deck, Half (5 Post)	1
S-1110-R	Filler, 12in	1
S-1206-24R45	ADA Stairs, 24in Rise w/ Walls	1
S-1209-24-R5	Transfer Station, 36in-L	1
S-1212-4R5	Climber, Vertical Step 42-48in	1
S-1216-DLX	Climber, Deluxe Grip 42-48in	1
S-1223-3R	Climber, Spiral 30-36in	1
S-1249-DGH	Climber, Inc. Geo-Wave 30-36in (H, DTG, R)	1
S-1303-R5	Single Slide SitDown Hood	1
S-1306-R5	Double Slide SitDown Hood	1
S-1309-2-R5	Half Walls (Pair) R5	5
S-1309-R5	Transfer Point (Half Wall - Left)	1
S-1310-R5	Transition Wall	1
S-1406-90R5	Traverse, Horizontal Ladder (7-Rung)	1
S-1414	Lily Pad Step 12-18in	1
S-1414-3-HH-R5	Climber, Step-Up 36in (Lily-Pad, Hand Rails)	1



Bill of Materials (continued)

Item	Description	Quantity
S-1414-C	Clover Seat	3
S-1514-45R5	Bridge, Inclined Arch (45in)	1
S-16071-R5G	Story Time Panel	1
S-1607-R5	Maze Panel	1
S-1614-R5	Slider Panel	1
S-1632-R5	Bug Eye Panel	1
S-1643-R5I	Pilot Panel	1
S-1655-3R5	Reach Panel, 36in	1
S-1662-R5	Panel Pal, ABC-123	1
S-1702-4R5	Slide, Wave 48in (Double)	1
S-1704-4	Slide, Wave 48in (Single)	1
S-1803-1821-R5	Roof, Hex w/ Flag	1
S-1807-1825-R5	Roof, Square Pyramid w/ Flag (Shingled)	1
S-1962-R5	Playseat	1
S-1980-R5	Counter Connection MT-5	1
HS-1100-2	Deck to Deck Hardware	3