

R505A58EA

TOP VIEW

ADA ACCESSIBILITY GUIDELINE - ADAAG CONFORMANCE

ELEVATED	ACCESSIBLE	RAMP ACCESSIBLE	GROUND	TYPES
19	19/10	0	5/6	3/3

R5

FOR KIDS
AGES
5-12

GENERAL NOTES:

This conceptual plan is based on information provided prior to construction. Detailed site information, including the following, should be obtained, evaluated, and utilized in the final project design. Exact site dimensions, topography, existing utilities, soil conditions and drainage solutions.

WARNING: Accessible safety surfacing material is required beneath and around this equipment that has a critical height value (Fall Height) appropriate for the highest accessible part of this equipment. Refer to the CPSC'S Handbook For Public Playground Safety, Section 4: Surfacing.

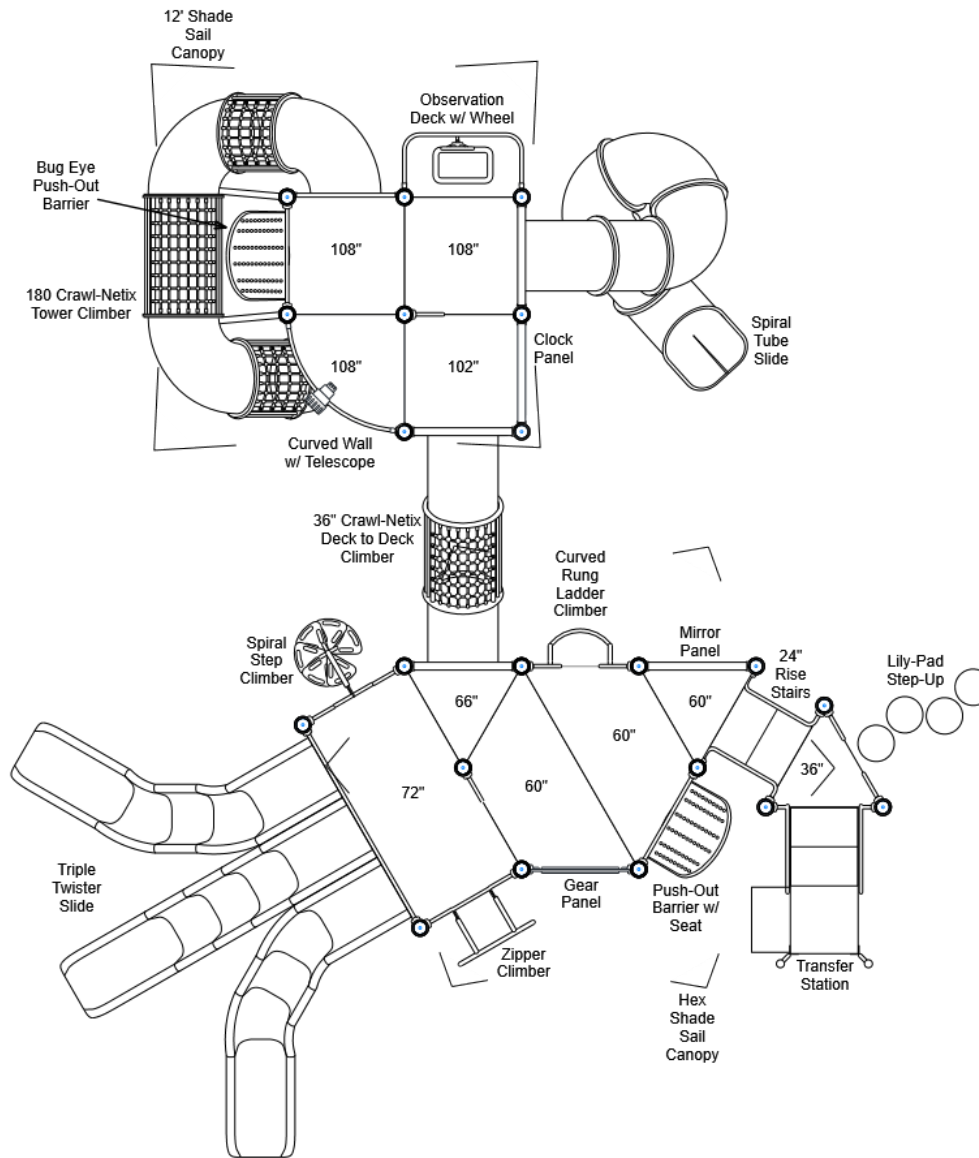

STRUCTURE#: R505A58EA

PROJECT#: R505A58EA

DATE: 9/23/2020 | DRAWN BY:

MIN. USE ZONE: 44' x 48'

PLAYCRAFT REP:

Playcraft Direct, Inc.



R505A58EA
TOP VIEW

ADA ACCESSIBILITY GUIDELINE - ADAAG CONFORMANCE

ELEVATED	ACCESSIBLE	RAMP ACCESSIBLE	GROUND	TYPES
19	19/10	0	5/6	3/3

R5

FOR KIDS
AGES
5-12

GENERAL NOTES:

This conceptual plan is based on information provided prior to construction. Detailed site information, including the following, should be obtained, evaluated, and utilized in the final project design. Exact site dimensions, topography, existing utilities, soil conditions and drainage solutions.

WARNING: Accessible safety surfacing material is required beneath and around this equipment that has a critical height value (Fall Height) appropriate for the highest accessible part of this equipment. Refer to the CPSC'S Handbook For Public Playground Safety, Section 4: Surfacing.

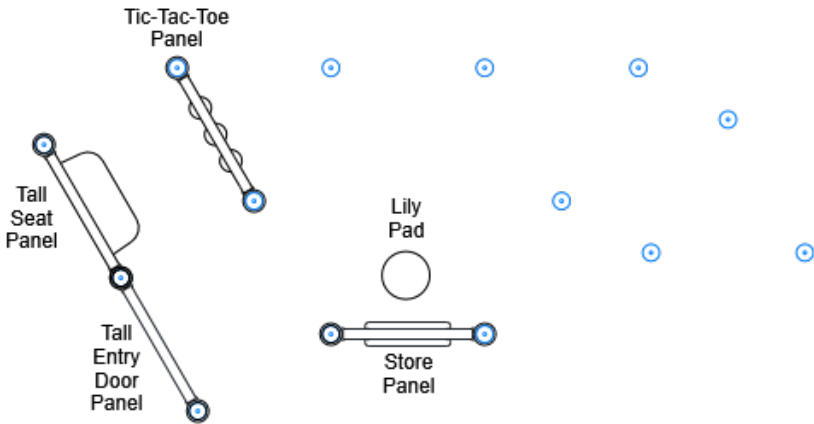
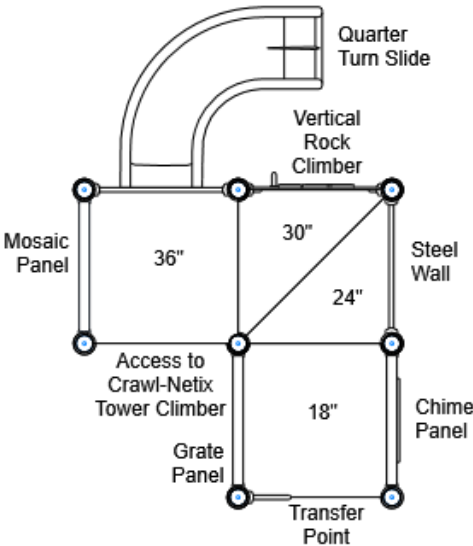

STRUCTURE#: R505A58EA
PROJECT#: R505A58EA
DATE: 9/23/2020 | DRAWN BY:

MIN. USE ZONE: 44' x 48'

PLAYCRAFT REP:
Playcraft Direct, Inc.



R505A58EA SITE PLAN

ADA ACCESSIBILITY GUIDELINE - ADAAG CONFORMANCE

ELEVATED	ACCESSIBLE	RAMP ACCESSIBLE	GROUND	TYPES
19	19/10	0	5/6	3/3



GENERAL NOTES:

This Preliminary Site Plan is based on measurements that were provided in the initial planning phase. All dimensions must be verified prior to the submission of a purchase order. Playcraft Systems will not be held responsible for any discrepancies between actual dimensions and dimensions submitted in the planning phase.

The Minimum Use Zone for a play structure is based on the product design at the time of proposal. Components and structure designs may be subject to change which may affect dimensions. Therefore, before preparing the site, we strongly recommend obtaining final drawings from the factory (available after the order is placed and included in the Assembly Manual).

WARNING: Accessible safety surfacing material is required beneath and around this equipment that has a critical height value (Fall Height) appropriate for the highest accessible part of this equipment. Refer to the CPSC'S Handbook For Public Playground Safety, Section 4: Surfacing.

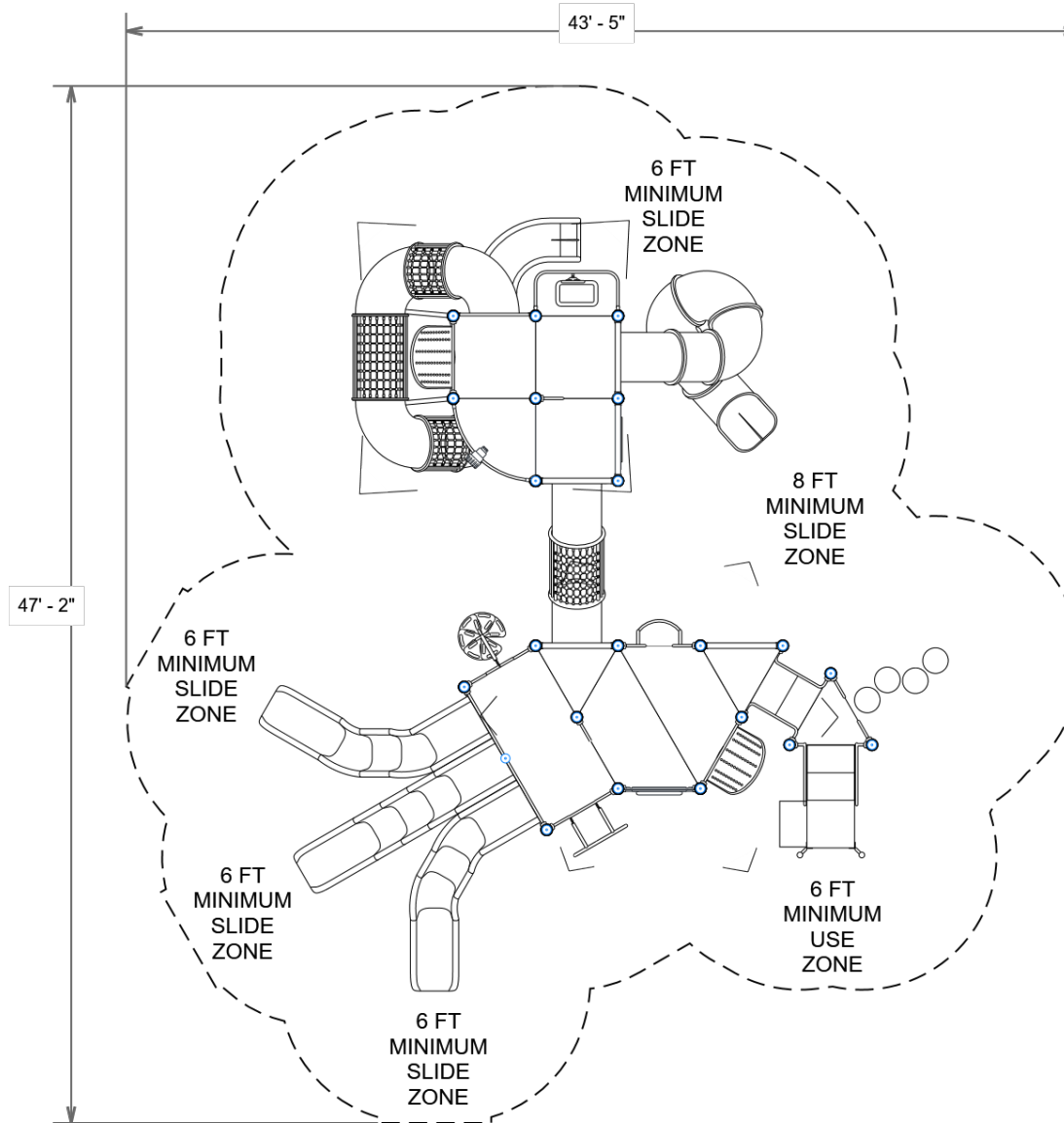

PROJECT#: R505A58EA

DATE: 9/23/2020 | DRAWN BY:

MIN. USE ZONE: 44' x 48'

PLAYCRAFT REP:

Playcraft Direct, Inc.



R505A58EA
SW VIEW

R5

FOR KIDS
AGES
5-12



STRUCTURE#: R505A58EA

PROJECT#: R505A58EA

DATE: 9/23/2020 | DRAWN BY:

R505A58EA
NE VIEW

R5

FOR KIDS
AGES
5-12



STRUCTURE#: R505A58EA

PROJECT#: R505A58EA

DATE: 9/23/2020 | DRAWN BY:



Bill of Materials

R505A58EA

Project# R505A58EA

9/23/2020

Item	Description	Quantity
R505A58EA		
HS-1004-R	Collars	114
GF-7002	Dome Cap, R5	12
S-1008-R5-08ft	Post, 08ft R5	1
S-1010-R5-10ft	Post, 10ft R5	1
S-1011-R5-11ft	Post, 11ft R5	2
S-1012-R5-12ft	Post, 12ft R5	1
S-1013-R5-13ft	Post, 13ft R5	3
S-1016-R5-16ft	Post, 16ft R5	4
S-1017-R5-17ft	Post, 17ft R5	6
S-1020-R5-20ft	Post, 20ft R5	4
S-1101-R5	Square Deck	5
S-1102-R5	Tri-Deck	3
S-1104-R5-90	Long Deck (90in)	1
S-1105-R5	Half Deck	2
S-1106-R5	Hex Deck, Half (4 Post)	2
S-1107-R5	Curved Deck	1
S-1109-LRG-R5-OB-W	Observation Deck w/ Wheel	1
S-1110-R	Filler, 12in	1
S-1206-24R5	ADA Stairs, 24in Rise w/ Walls (Short)	1
S-1209-24-R5	Transfer Station, 36in-L	1
S-1227-6R5	Climber, Zipper 66-72in	1
S-1234-6R	Climber, Spiral Step 66-72in	1
S-1237-3R5	Climber, Vertical Rock 30-36in	1
S-1282-5	Climber, Curved Rung Ladder 54-60in	1
S-1301-R5	Wall, Steel 36in (Standard)	1



Bill of Materials (continued)

Item	Description	Quantity
S-1304-R5	Single Slide SitDown Wall	1
S-1309-2-R5	Half Walls (Pair) R5	2
S-1309-R5	Transfer Point (Half Wall - Left)	1
S-1309-R5	Half Walls (Single, Right)	1
S-1309-R5	Half Walls (Single, Left)	1
S-1310-R5	Transition Wall	1
S-1328-1830-R5	Steel Wall (Curved w/ Telescope)	1
S-1333-R5G-T	Seat Panel, Tall (Ground)	1
S-1362-13112-R5	Push-Out Barrier (w/ Seat)	1
S-1362-16132-R5	Push-Out Barrier (Bug Eye)	1
S-1414	Lily Pad Seat	1
S-1414-3	Climber, Step-Up 36in (Lily-Pad)	1
S-1535-3DTD-V2	Climber, Crawl-Netix 36in (DTD, 36)	1
S-1536-6R	Climber, Crawl-Netix Tower (180, Right)	1
S-1604-R5	Chime Panel	1
S-1605-R5	Clock Panel	1
S-1609-R5	Mirror Panel	1
S-1615-R5G	Store Panel	1
S-1616-R5G	Tic-Tac-Toe Panel	1
S-1626-R5	Grate Panel	1
S-1644-R5	Gear Panel	1
S-1653-R5	Door Panel (Tall Entry)	1
S-1685-R5	Mosaic Panel	1
S-1705-3	Slide, Quarter Turn 36in	1
S-1707-9SPR5	Slide, Tube 108in (Spiral, Left)	1
S-1710-3-6R5-L2S5R2	Slide, Triple Twister 72in (L2-S5-R2)	1
S-18027-R512	Shade Sail Canopy, 12ft	1
S-18028-R514	Shade Sail, Hex 14ft	1
HS-1100-2	Deck to Deck Hardware	4