

# R504F0C3A TOP VIEW

ADA ACCESSIBILITY GUIDELINE - ADAAG CONFORMANCE

ELEVATED	ACCESSIBLE	RAMP ACCESSIBLE	GROUND	TYPES
19	19/10	0	8/6	4/3

R5

FOR KIDS  
AGES  
2-5

## GENERAL NOTES:

This conceptual plan is based on information provided prior to construction. Detailed site information, including the following, should be obtained, evaluated, and utilized in the final project design. Exact site dimensions, topography, existing utilities, soil conditions and drainage solutions.

WARNING: Accessible safety surfacing material is required beneath and around this equipment that has a critical height value (Fall Height) appropriate for the highest accessible part of this equipment. Refer to the CPSC's Handbook For Public Playground Safety, Section 4: Surfacing.

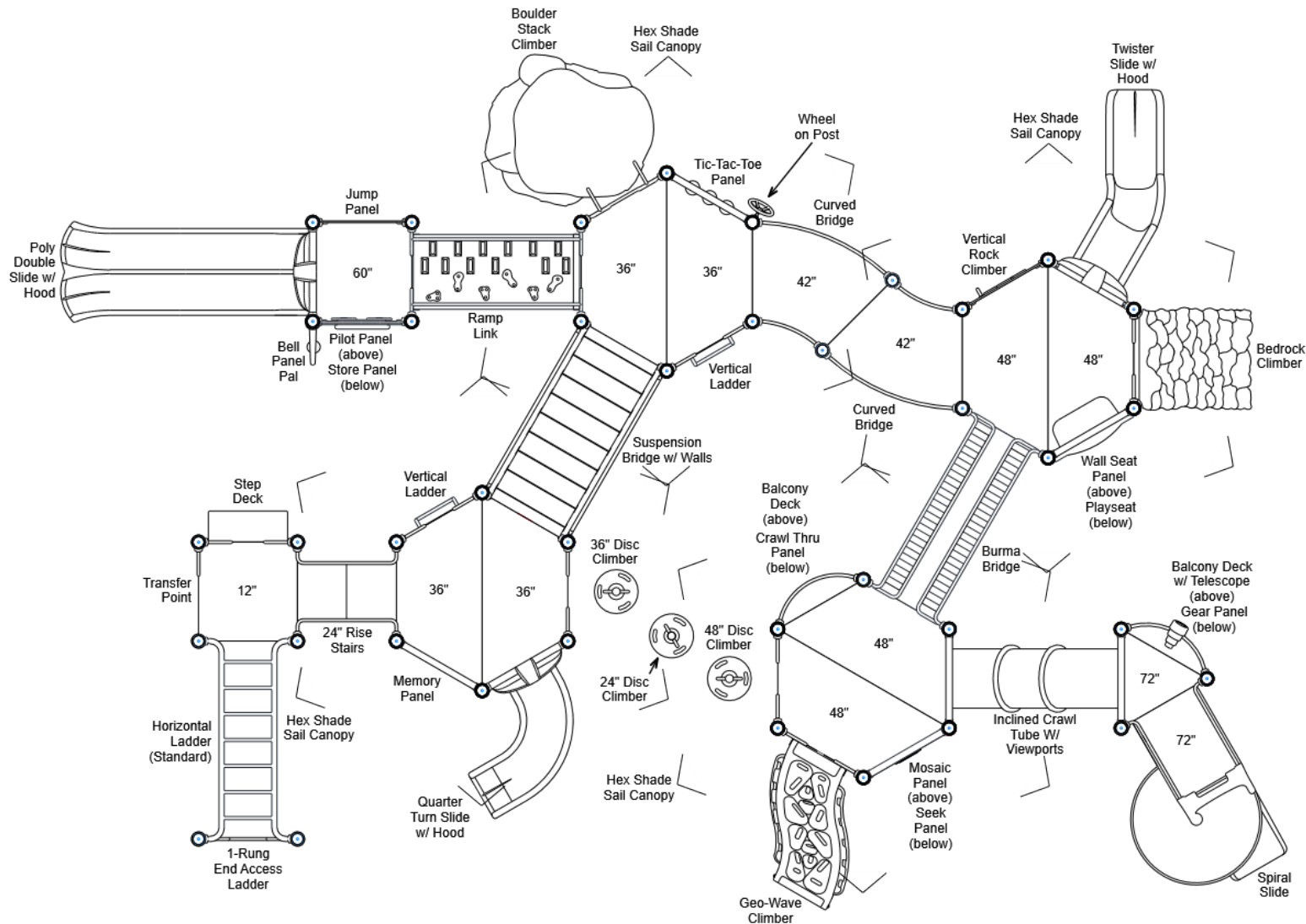

STRUCTURE#: R504F0C3A

PROJECT#: R504F0C3A

DATE: 10/3/2019

MIN. USE ZONE: 59' x 45'

PLAYCRAFT REP:

Playcraft Direct, Inc.



# R504F0C3A SITE PLAN

ADA ACCESSIBILITY GUIDELINE - ADAAG CONFORMANCE

ELEVATED	ACCESSIBLE	RAMP ACCESSIBLE	GROUND	TYPES
19	19/10	0	8/6	4/3

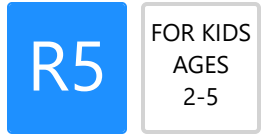

## GENERAL NOTES:

This Preliminary Site Plan is based on measurements that were provided in the initial planning phase. All dimensions must be verified prior to the submission of a purchase order. Playcraft Systems will not be held responsible for any discrepancies between actual dimensions and dimensions submitted in the planning phase.

The Minimum Use Zone for a play structure is based on the product design at the time of proposal. Components and structure designs may be subject to change which may affect dimensions. Therefore, before preparing the site, we strongly recommend obtaining final drawings from the factory (available after the order is placed and included in the Assembly Manual).

**WARNING:** Accessible safety surfacing material is required beneath and around this equipment that has a critical height value (Fall Height) appropriate for the highest accessible part of this equipment. Refer to the CPSC'S Handbook For Public Playground Safety, Section 4: Surfacing.

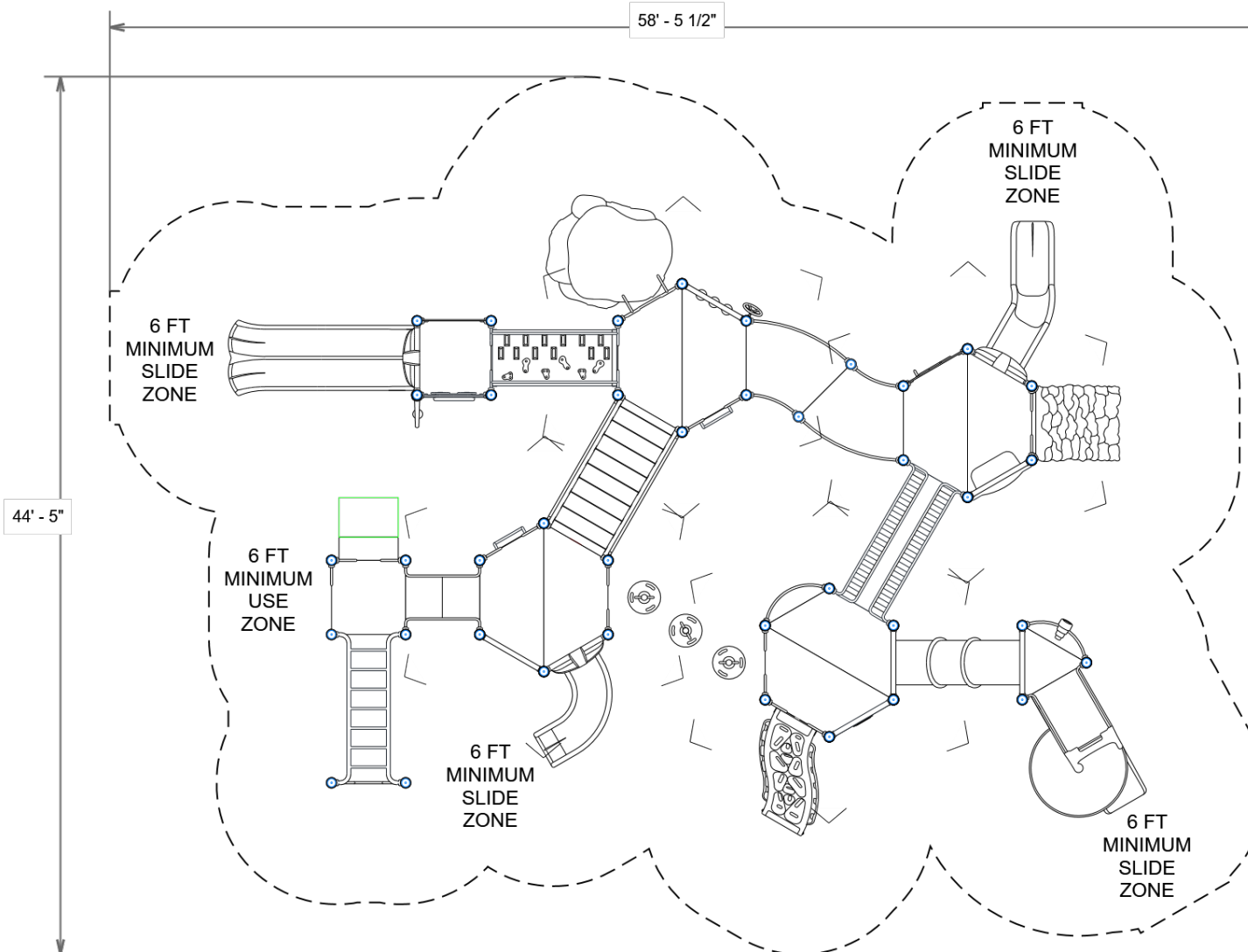

PROJECT#: R504F0C3A  
DATE: 10/3/2019

MIN. USE ZONE: 59' x 45'

PLAYCRAFT REP:  
**Playcraft Direct, Inc.**



**R504F0C3A**  
**SW VIEW**

**R5**

FOR KIDS  
AGES  
2-5

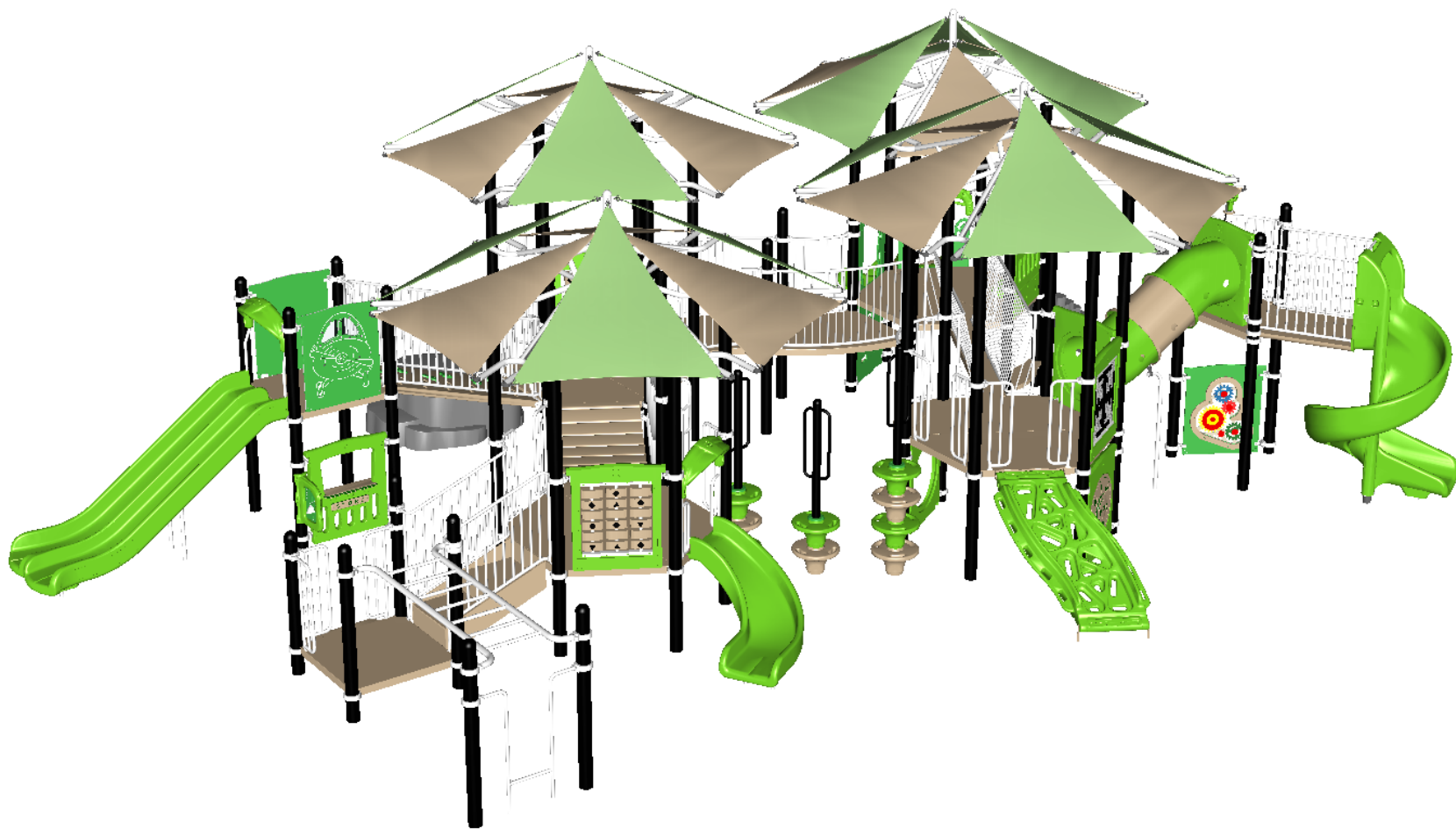

STRUCTURE#: R504F0C3A  
PROJECT#: R504F0C3A  
DATE: 10/3/2019



**R504F0C3A**  
**SE VIEW**

**R5**

FOR KIDS  
AGES  
2-5



STRUCTURE#: R504F0C3A  
PROJECT#: R504F0C3A  
DATE: 10/3/2019

**R504F0C3A**  
**NE VIEW**

**R5**

FOR KIDS  
AGES  
2-5



STRUCTURE#: R504F0C3A  
PROJECT#: R504F0C3A  
DATE: 10/3/2019

**R504F0C3A**  
**NW VIEW**

**R5**

FOR KIDS  
AGES  
2-5

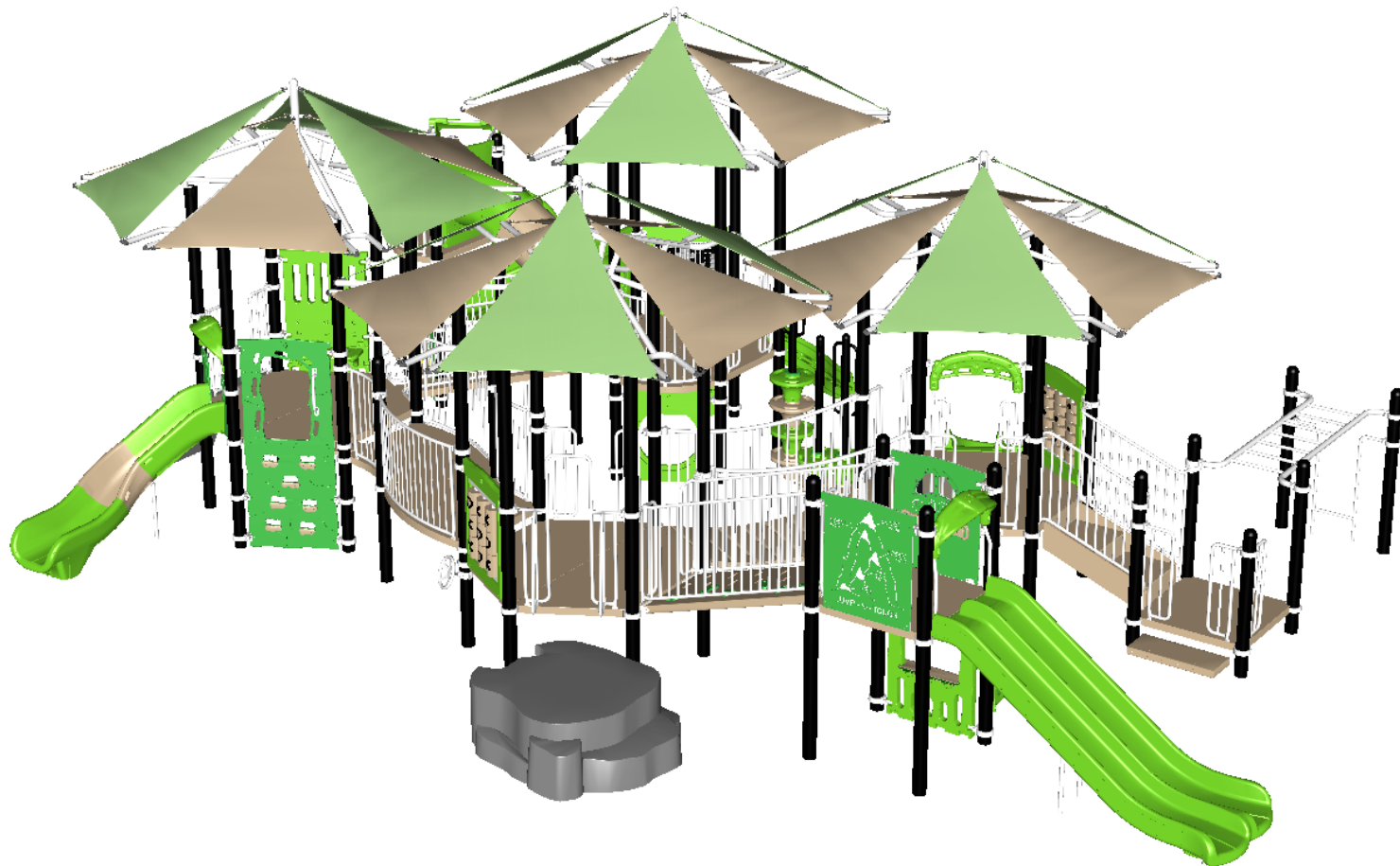

STRUCTURE#: R504F0C3A  
PROJECT#: R504F0C3A  
DATE: 10/3/2019







## Bill of Materials

R504F0C3A

Project# R504F0C3A

10/3/2019

Item	Description	Quantity
R504F0C3A		
HS-1004-R	Collars	126
GF-7002	Dome Cap, R5	15
S-1008-R5-08ft	Post, 08ft R5	1
S-1009-R5-09ft	Post, 09ft R5	5
S-1011-R5-11ft	Post, 11ft R5	2
S-1012-R5-12ft	Post, 12ft R5	4
S-1013-R5-13ft	Post, 13ft R5	3
S-1014-R5-14ft	Post, 14ft R5	6
S-1015-R5-15ft	Post, 15ft R5	12
S-1016-R5-16ft	Post, 16ft R5	6
S-1101-R5	Square Deck	2
S-1102-R5	Tri-Deck	1
S-1106-R5	Hex Deck, Half (4 Post)	8
S-1109-R5	Balcony Deck	1
S-1109-R5-T	Balcony Deck w/ Telescope	1
S-1202-R5	Step Deck, 12in	1
S-1206-24R45	ADA Stairs, 24in Rise w/ Walls	1
S-1210-36	Climber, Vertical Ladder 30-36in	2
S-1228-4	Climber, Bedrock 48in	1
S-1233-2-MC	Climber, Disc 18-24in	1
S-1233-3-HW	Climber, Disc 30-36in (w/ HW)	1
S-1233-4-HW	Climber, Disc 42-48in (w/ HW)	1
S-1237-4R5	Climber, Vertical Rock 42-48in	1
S-1249-DGH	Climber, Incl. Geo-Wave 42-48in (Horiz, DTG Left)	1
S-1290-D1-R5	Climber, Boulder Stack 36in (Base Rock)	1



# Bill of Materials (continued)

Item	Description	Quantity
S-1303-R5	Single Slide SitDown Hood	1
S-1303-TW-R5	Twister Entry Panel w/ Hood	1
S-1306-R5	Double Slide SitDown Hood	1
S-1309-2-R5	Half Walls (Pair) R5	6
S-1309-R5	Half Walls (Single, Left)	1
S-1333-R5-T	Wall Seat Panel (Tall)	1
S-1401-R5	End Access Ladder (1-Rung)	1
S-1406-90R5	Traverse, Horizontal Ladder (7-Rung)	1
S-1500-3IR5	Crawl Tube, 24in Incl. (3-Sect., 48in High)	1
S-1506-W-90R5	Bridge, Suspension w/ Walls	1
S-1509-90R5	Bridge, Burma (90in)	1
S-1511-R5	Bridge, Curved	2
S-1525-R5	Link, Ramp (Inclined 24in)	1
S-1600-R5G	Crawl Thru Panel	1
S-1608-R5	Memory Panel	1
S-1615-R5	Store Panel	1
S-1616-R5	Tic-Tac-Toe Panel	1
S-1618-R5G	Seek Panel	1
S-1620-R5	Jump Panel	1
S-1643-R5	Pilot Panel	1
S-1644-R5G	Gear Panel	1
S-1661-R5	Panel Pal, Bell	1
S-1685-R5	Mosaic Panel	1
S-1702-5R5	Slide, Double 60in	1
S-1705-3	Slide, Quarter Turn 36in	1
S-1706-R5	Slide, Spiral 72in	1
S-1710-4-L	Slide, Twister 48in (L)	1
S-18028-R514	Shade Sail, Hex 14ft	4
S-1812-R5	Driver Wheel (Post Mounted)	1
S-1962-R5	Playseat	1





## Bill of Materials (continued)

Item	Description	Quantity
HS-1100-2	Deck to Deck Hardware	3