

R50498CAA
TOP VIEW

ADA ACCESSIBILITY GUIDELINE - ADAAG CONFORMANCE

ELEVATED	ACCESSIBLE	RAMP ACCESSIBLE	GROUND	TYPES
6	3/3	0	3/2	2/2

R5

FOR KIDS
AGES
5-12

GENERAL NOTES:

This conceptual plan is based on information provided prior to construction. Detailed site information, including the following, should be obtained, evaluated, and utilized in the final project design. Exact site dimensions, topography, existing utilities, soil conditions and drainage solutions.

WARNING: Accessible safety surfacing material is required beneath and around this equipment that has a critical height value (Fall Height) appropriate for the highest accessible part of this equipment. Refer to the CPSC'S Handbook For Public Playground Safety, Section 4: Surfacing.

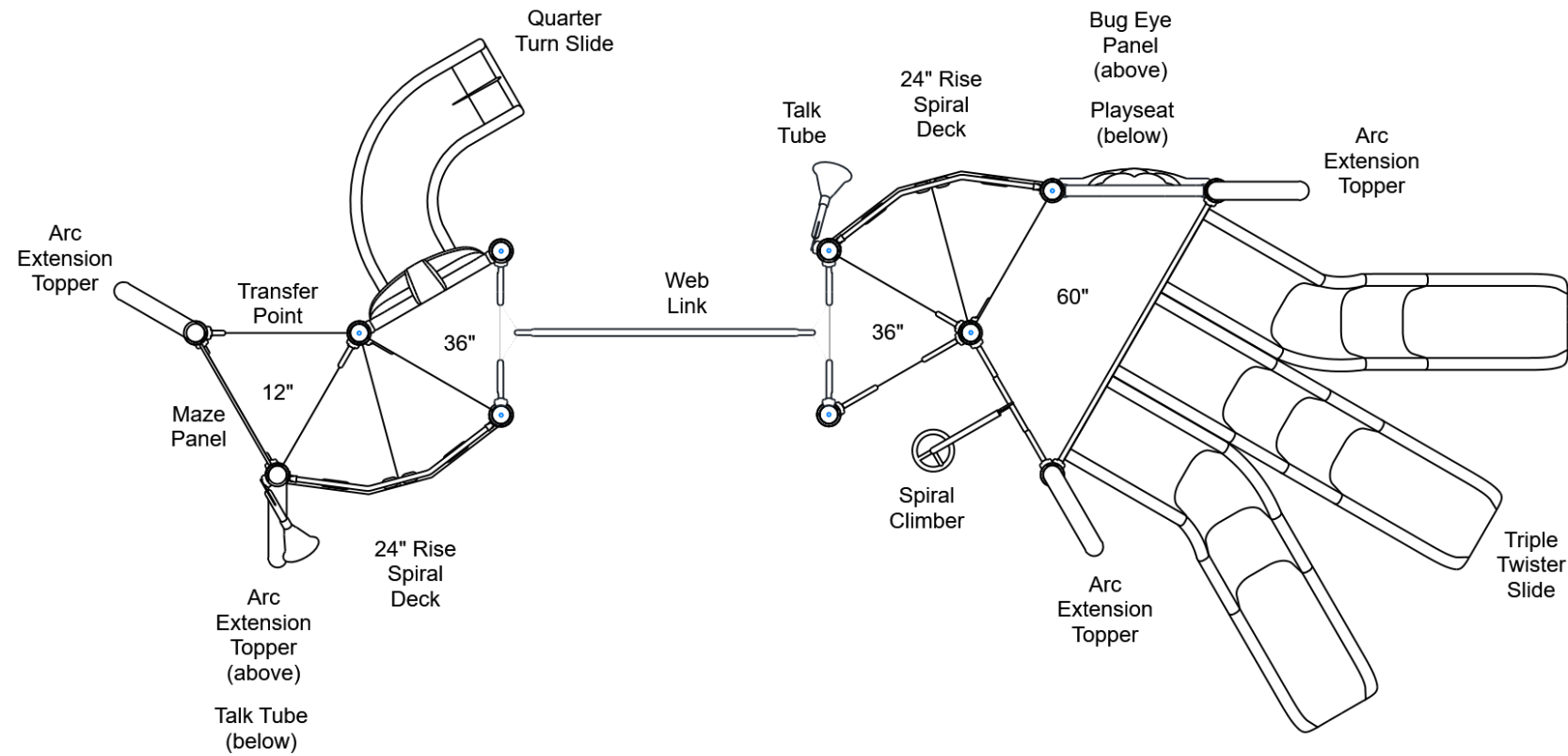

STRUCTURE#: R50498CAA
PROJECT#: R50498CAA
DATE: 1/27/2023

MIN. USE ZONE: 44' x 28'

PLAYCRAFT REP:
Playcraft Direct, Inc.

R50498CAA SITE PLAN

ADA ACCESSIBILITY GUIDELINE - ADAAG CONFORMANCE

ELEVATED	ACCESSIBLE	RAMP ACCESSIBLE	GROUND	TYPES
6	3/3	0	3/2	2/2

R5

FOR KIDS
AGES
5-12

GENERAL NOTES:

This Preliminary Site Plan is based on measurements that were provided in the initial planning phase. All dimensions must be verified prior to the submission of a purchase order. Playcraft Systems will not be held responsible for any discrepancies between actual dimensions and dimensions submitted in the planning phase.

The Minimum Use Zone for a play structure is based on the product design at the time of proposal. Components and structure designs may be subject to change which may affect dimensions. Therefore, before preparing the site, we strongly recommend obtaining final drawings from the factory (available after the order is placed and included in the Assembly Manual).

WARNING: Accessible safety surfacing material is required beneath and around this equipment that has a critical height value (Fall Height) appropriate for the highest accessible part of this equipment. Refer to the CPSC'S Handbook For Public Playground Safety, Section 4: Surfacing.

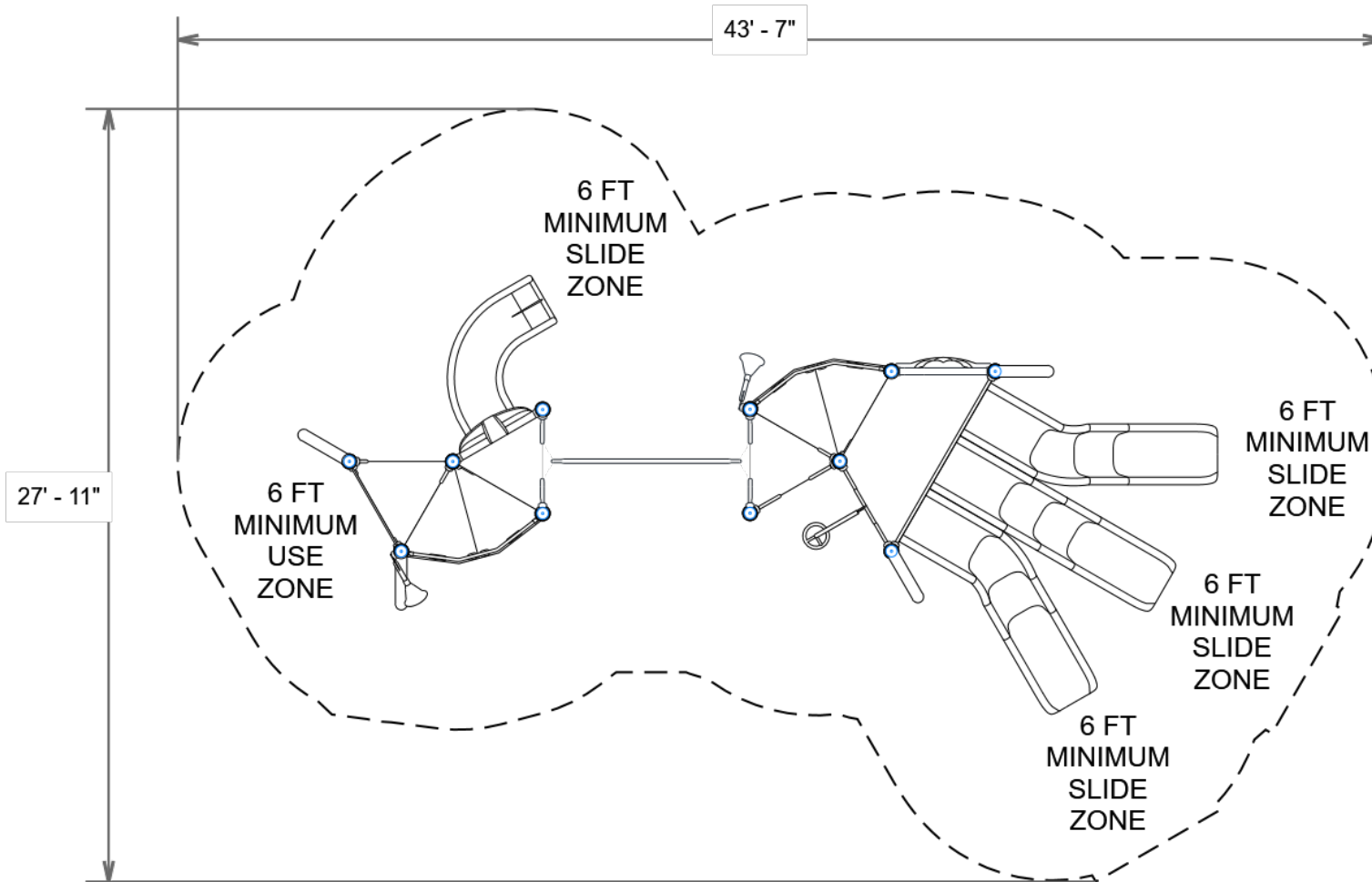

PROJECT#: R50498CAA
DATE: 1/27/2023

MIN. USE ZONE: 44' x 28'

PLAYCRAFT REP:
Playcraft Direct, Inc.

R50498CAA
SW VIEW

R5

FOR KIDS
AGES
5-12

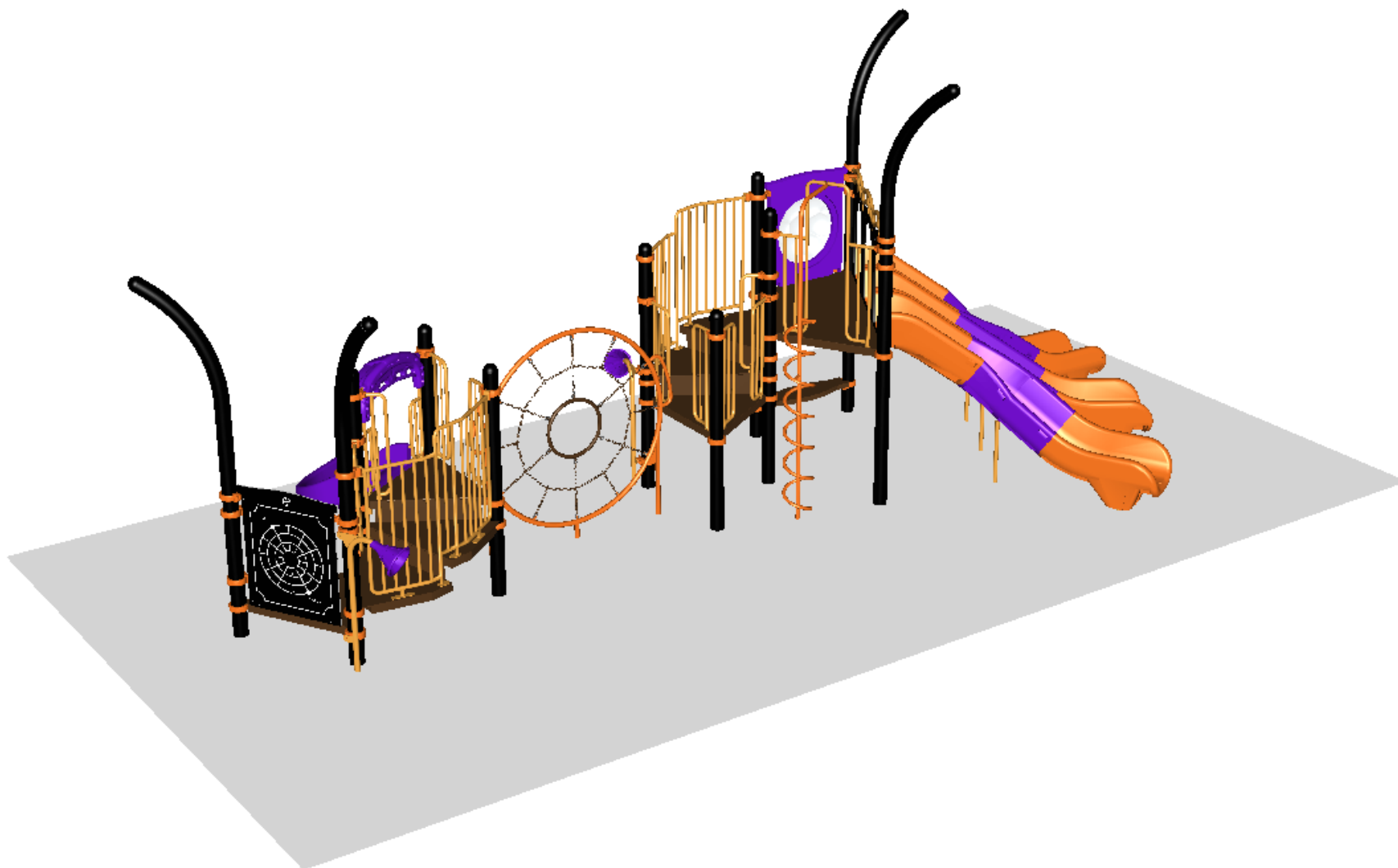

STRUCTURE#: R50498CAA
PROJECT#: R50498CAA
DATE: 1/27/2023

R50498CAA
NE VIEW

R5

FOR KIDS
AGES
5-12

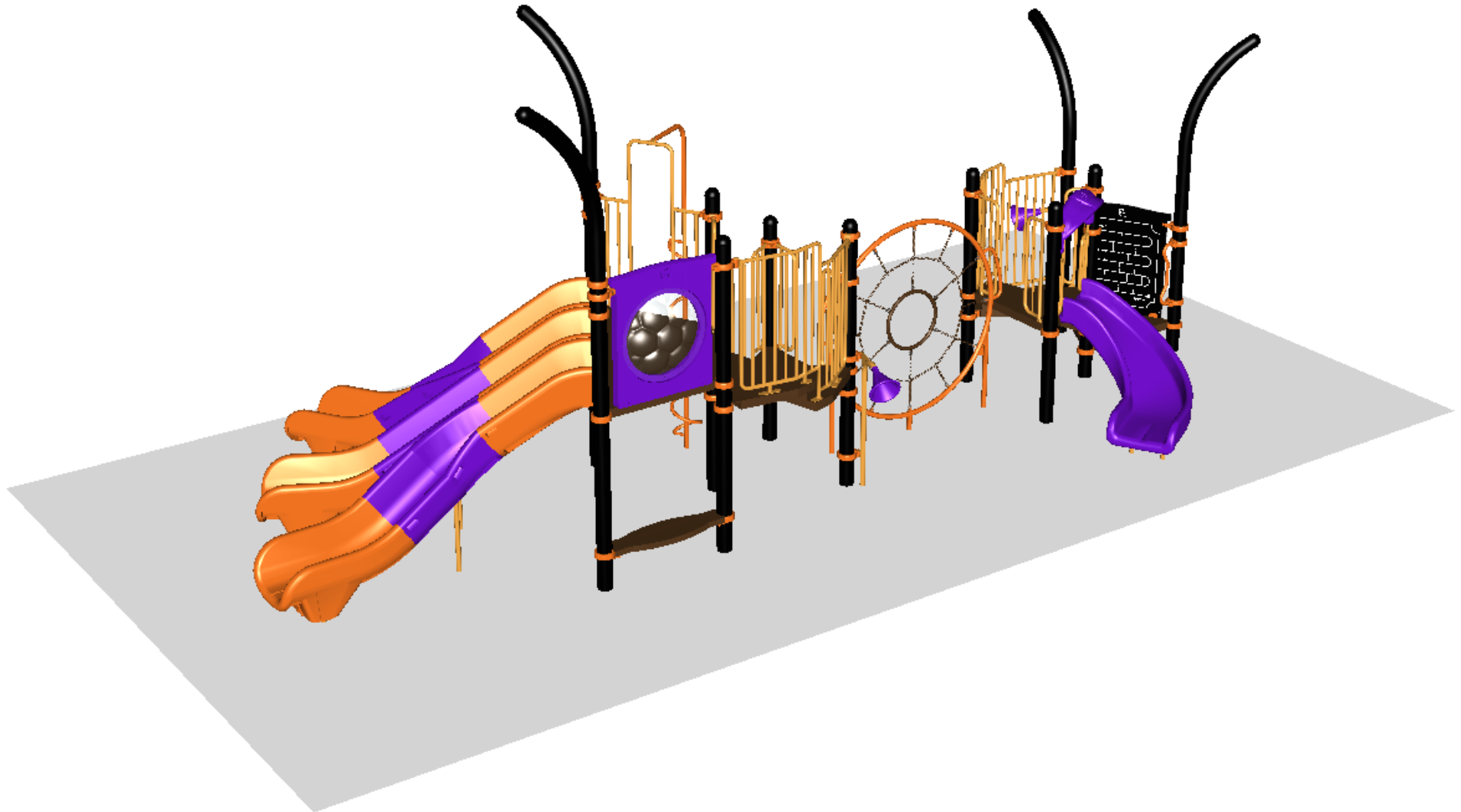

STRUCTURE#: R50498CAA
PROJECT#: R50498CAA
DATE: 1/27/2023



Bill of Materials

R50498CAA

Project# R50498CAA

1/27/2023

Item	Description	Quantity
R50498CAA		
HS-1004-R	Collars	49
GF-7002	Dome Cap, R5	7
S-1009-R5-09ft	Post, 09ft R5	2
S-1010-R5-10ft	Post, 10ft R5	4
S-1011-R5-11ft	Post, 11ft R5	1
S-1012-R5-12ft	Post, 12ft R5	4
S-11021-L	Spiral Deck, (Left, 24in)	1
S-11021-R	Spiral Deck, (Right, 24in)	1
S-1102-R5	Tri-Deck	3
S-1106-R5	Hex Deck, Half (4 Post)	1
S-1223-5R	Climber, Spiral 54-60in	1
S-1303-R5	Single Slide SitDown Hood	1
S-1309-2-R5	Half Walls (Pair) R5	1
S-1310-R5	Transition Wall	1
S-1313-R5	Handle	1
S-1517-R5	Link, Web 36in	1
S-1607-R5	Maze Panel	1
S-1632-R5	Bug Eye Panel	1
S-1705-3	Slide, Quarter Turn 36in	1
S-1710-3-5R5-LS4R	Slide, Triple Twister 60in (L-S-R)	1
S-1850-R5	Arc Extension Topper	4
S-1910-R5	Talk Tube (Post Mounted, Left)	1
S-1910-R5	Talk Tube (Post Mounted, Right)	1
S-1962-R5	Playseat	1