

R502C9BEA  
TOP VIEW

ADA ACCESSIBILITY GUIDELINES - ADAAG CONFORMANCE

ELEVATED	ACCESSIBLE	RAMP ACCESSIBLE	GROUND	TYPES
23	23/6	12/6	26/0	4/0
CHILD CAPACITY	261	MAX FALL HEIGHT	96	

R5

FOR KIDS  
AGES  
5-12

GENERAL NOTES

This conceptual plan is based on information provided prior to construction. Detailed site information, including the following, should be obtained, evaluated, and utilized in the final project design. Exact site dimensions, topography, existing utilities, soil conditions and drainage solutions.

WARNING: Accessible safety surfacing material is required beneath and around this equipment that has a critical height value (Fall Height) appropriate for the highest accessible part of this equipment. Refer to the CPSC'S Handbook For Public Playground Safety, Section 4: Surfacing.

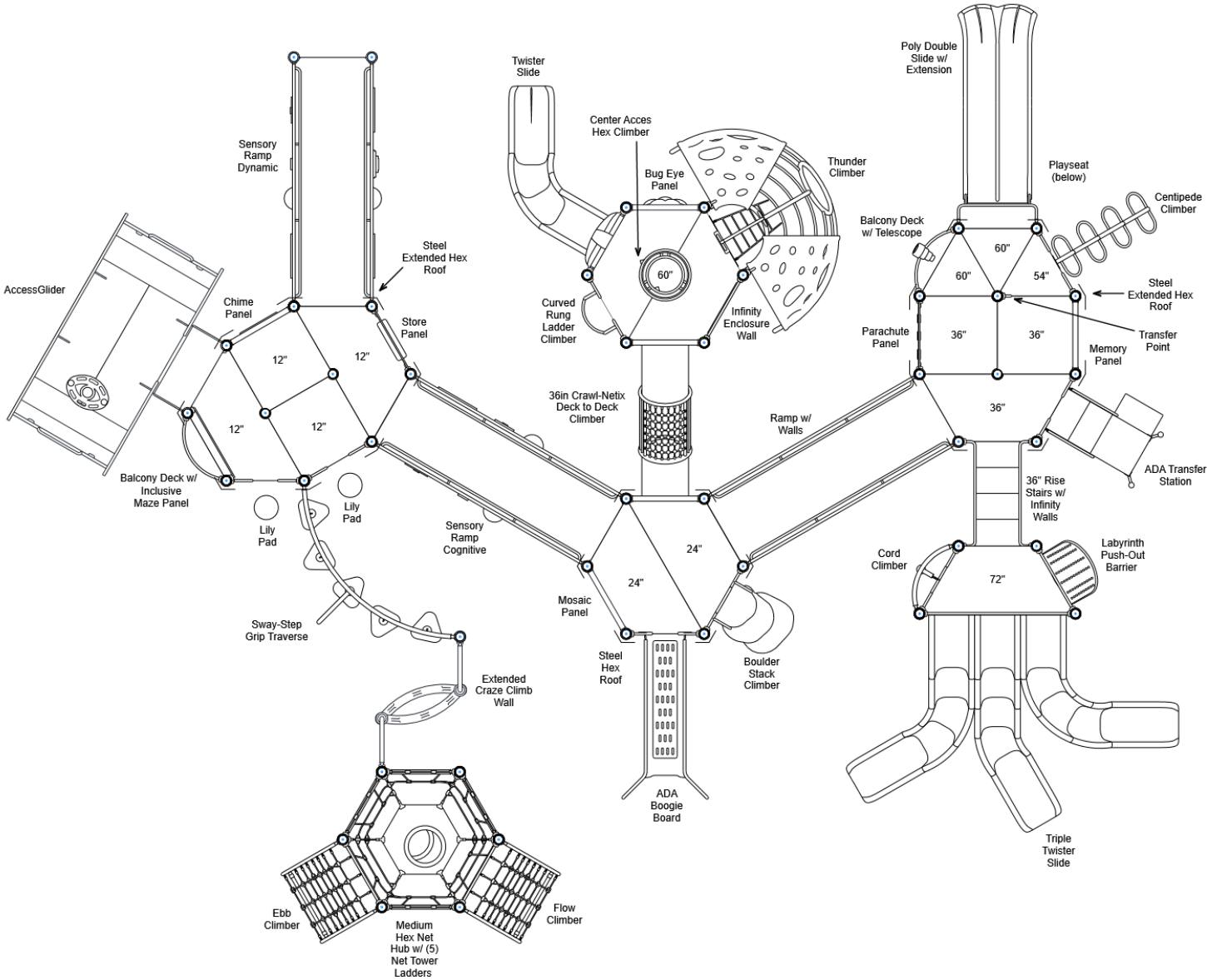

STRUCTURE # R502C9BEA  
PROJECT # R502C9BEA  
DATE 11/6/2023

Playcraft Direct, Inc.  
MIN. USE ZONE 69' x 58' (20.824m x 17.415m)



R502C9BEA  
SITE PLAN

ADA ACCESSIBILITY GUIDELINES - ADAAG CONFORMANCE

ELEVATED	ACCESSIBLE	RAMP ACCESSIBLE	GROUND	TYPES
23	23/6	12/6	26/0	4/0

R5

FOR KIDS  
AGES  
5-12

GENERAL NOTES

This Preliminary Site Plan is based on measurements that were provided in the initial planning phase. All dimensions must be verified prior to the submission of a purchase order. Playcraft Systems will not be held responsible for any discrepancies between actual dimensions and dimensions submitted in the planning phase.

The Minimum Use Zone for a play structure is based on the product design at the time of proposal. Components and structure designs may be subject to change which may affect dimensions. Therefore, before preparing the site, we strongly recommend obtaining final drawings from the factory (available after the order is placed and included in the Assembly Manual).

WARNING: Accessible safety surfacing material is required beneath and around this equipment that has a critical height value (Fall Height) appropriate for the highest accessible part of this equipment. Refer to the CPSC'S Handbook For Public Playground Safety, Section 4: Surfacing.

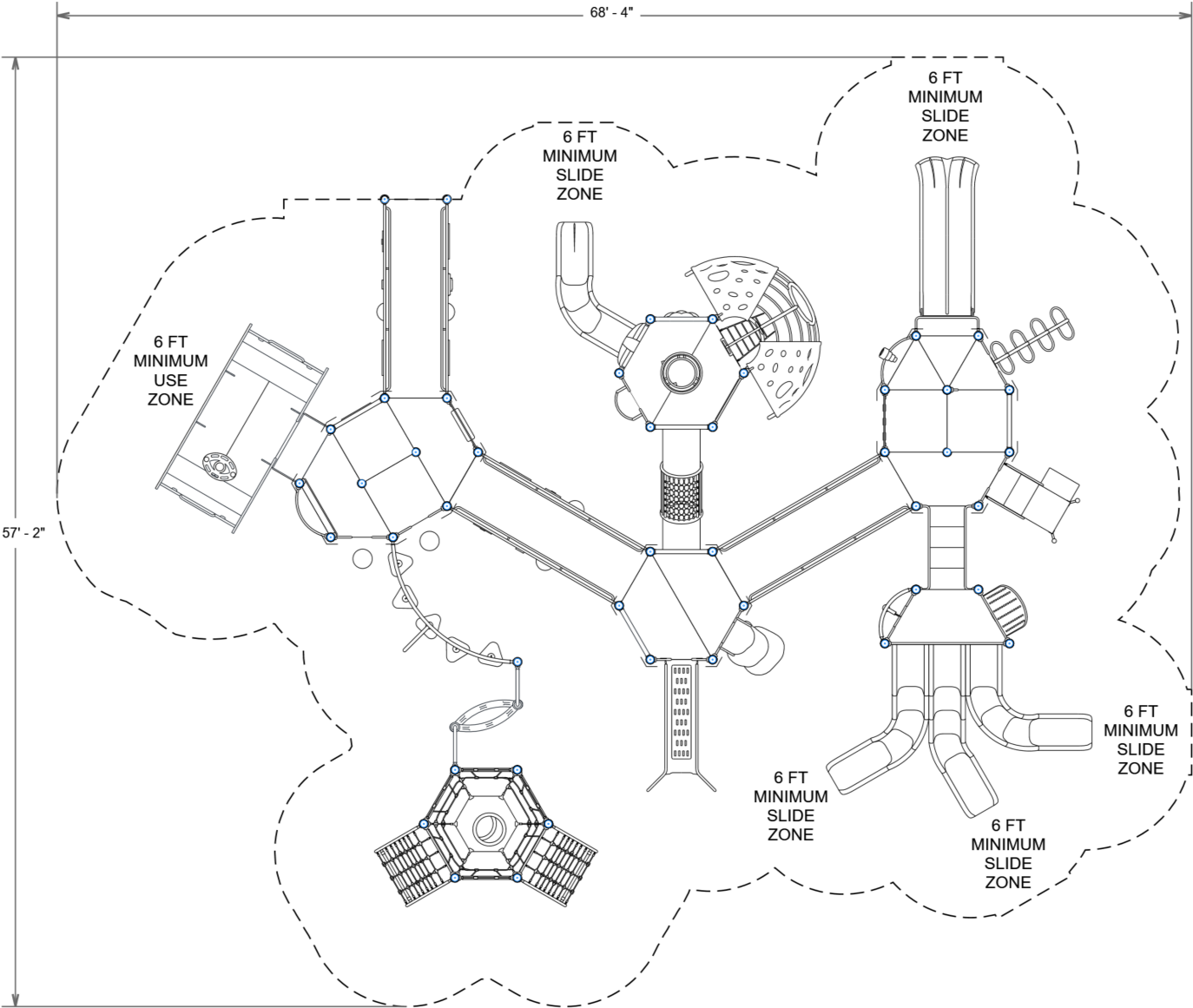

**R502C9BEA**  
**SW VIEW**

**R5**

FOR KIDS  
AGES  
5-12

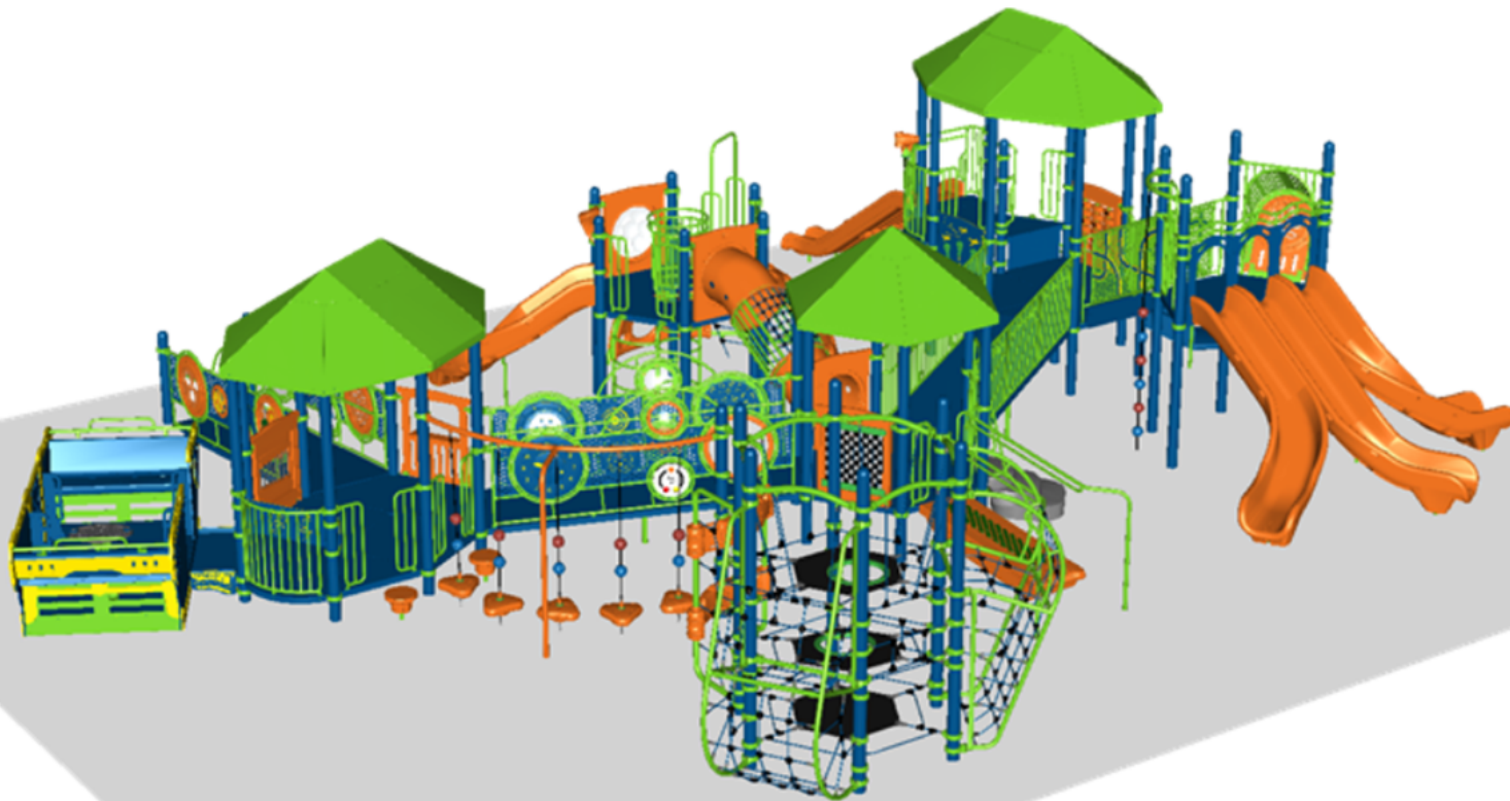

**STRUCTURE #** R502C9BEA  
**PROJECT #** R502C9BEA  
**DATE** 11/6/2023

**R502C9BEA**  
**NE VIEW**

**R5**

FOR KIDS  
AGES  
5-12



**STRUCTURE #** R502C9BEA  
**PROJECT #** R502C9BEA  
**DATE** 11/6/2023

**R502C9BEA**
**Project #** R502C9BEA

**Date** 11/6/2023

Item / Part Number	Description	Qty
<b>[R502C9BEA]</b>		
HS-1004-R	Collars	170
GF-7001	Flat Cap, R5	3
GF-7002	Dome Cap, R5	20
S-1005-R5F-9-012-051	Post, 5ft, 12in (51in)	2
S-1007-R5-07ft	Post, 07ft R5	2
S-1007-R5F-9-036-075	Post, 7ft, 36in (75in)	1
S-1011-R5-11ft	Post, 11ft R5	1
S-1012-R5-12ft	Post, 12ft R5	21
S-1014-R5-14ft	Post, 14ft R5	6
S-1015-R5-15ft	Post, 15ft R5	12
S-1101-R5	Square Deck	4
S-1102-R5	Tri-Deck	3
S-1103-R5	Hex Deck, Half (5 Post)	3
S-1106-R5	Hex Deck, Half (4 Post)	3
S-1109-R5	Balcony Deck	1
S-1109-R5-T	Balcony Deck w/ Telescope	1
S-1112-R	Filler, 18in	1
S-1206-36IW	ADA Stairs, 36in Rise w/ Infinity Walls	1
S-1208-R-WALL36	Ramp 144in (18-24in High w/ Walls, Inc.)	1
S-1208-SRC-12	Sensory Ramp 144in (6-12, Cognitive, Inc.)	1
S-1208-SRD	Sensory Ramp 144in (Ground, Dynamic, Inc.)	1
S-1209-24RHW	Transfer Station, 36in-R (RHW)	1
S-1211-R	Filler, Step - 24in, R5	1
S-1220-5	Climber, Centipede 54-60in	1
S-12401-R5	Climber, Thunder	1
S-1261-R5E-ND	Climber, Ebb	1
S-1261-R5F-ND	Climber, Flow	1
S-1282-5	Climber, Curved Rung Ladder 54-60in	1
S-12891-5-HEX	Center Access Hex Deck (60in)	1
S-1290-D3-R5	Climber, Boulder Stack 18-24in	1
S-1293-R5	Net Tower Ladder	5
S-1297-EXT	Climber, Craze Wall (Right, Extended)	1
S-1298-6R5	Climber, Cord 72in	1
S-1301-IW	Wall, Infinity (Standard)	1
S-1303-TW-R5	Twister Entry Panel w/ Hood	1
S-1309-2-R5	Half Walls (Pair) R5	4

<b>Item / Part Number</b>	<b>Description</b>	<b>Qty</b>
S-1310-R5	Transition Wall	1
S-1313-R5	Handle	1
S-1362-16134-R5	Push-Out Barrier (Labyrinth)	1
S-1414	Lily Pad Step 12-18in	2
S-1440-R5	Traverse, Sway-Step Grip	1
S-1535-3DTD-V2	Climber, Crawl-Netix 36in (DTD, 36)	1
S-1604-R5	Chime Panel	1
S-1608-R5	Memory Panel	1
S-1632-R5	Bug Eye Panel	1
S-16431-R5	Parachute Panel	1
S-1685-R5	Mosaic Panel	1
S-1688-R5	Inclusive Panel, Maze	1
S-16915-R5	Store Panel (CSA)	1
S-1702-1122-5	Slide, Double 60in (w/ Extn)	1
S-1710-3-6R5-L4S3R2	Slide, Triple Twister 72in (L4-S3-R2)	1
S-1710-5-RR	Slide, Twister 60in (R2)	1
S-1803-R5STL	Metal Roof, Hex	1
S-1806-R5STL	Metal Roof, Hex (Extended)	2
S-1925-R5-3	Hub, Hex Net (Medium)	1
S-1941-R5-ADA	Boogie Board ADA (w/ Half Walls)	1
S-1962-R5	Playseat	1
S-1975-R5	Trans-Glide	1