

R502AE2FA
TOP VIEW

ADA ACCESSIBILITY GUIDELINES - ADAAG CONFORMANCE

ELEVATED	ACCESSIBLE	RAMP ACCESSIBLE	GROUND	TYPES
11	9/6	0/0	11/4	4/3
CHILD CAPACITY	169	MAX FALL HEIGHT	144	

R5

FOR KIDS
AGES
5-12

GENERAL NOTES

This conceptual plan is based on information provided prior to construction. Detailed site information, including the following, should be obtained, evaluated, and utilized in the final project design. Exact site dimensions, topography, existing utilities, soil conditions and drainage solutions.

WARNING: Accessible safety surfacing material is required beneath and around this equipment that has a critical height value (Fall Height) appropriate for the highest accessible part of this equipment. Refer to the CPSC'S Handbook For Public Playground Safety, Section 4: Surfacing.

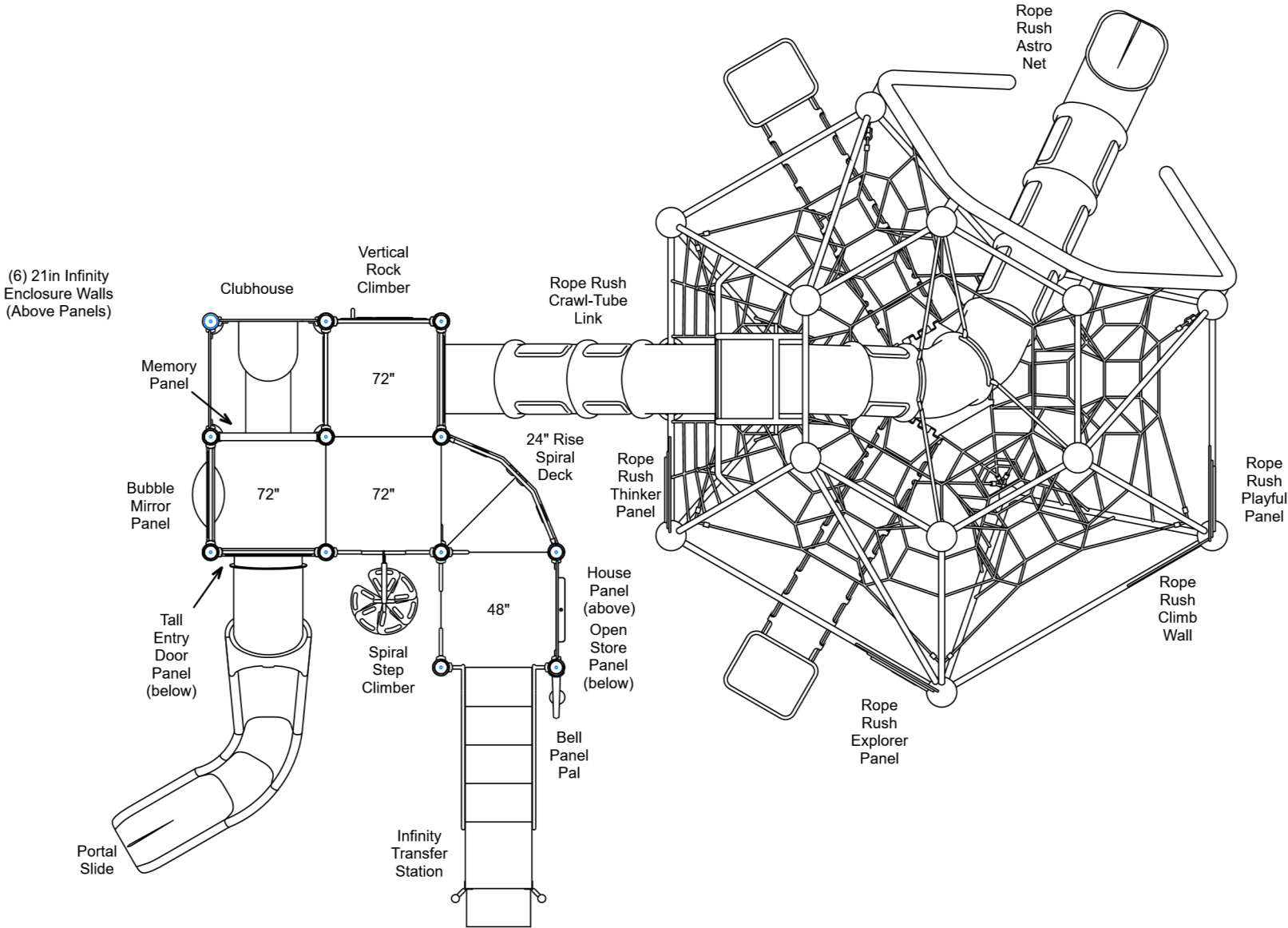

STRUCTURE # R502AE2FA
PROJECT # R502AE2FA
DATE 10/14/2024

Playcraft Direct, Inc.
MIN. USE ZONE 59' x 44' (17.971m x 13.389m)



TOP VIEW

ELEVATED	ACCESSIBLE	RAMP ACCESSIBLE	GROUND	TYPES
11	9/6	0/0	11/4	4/3
CHILD CAPACITY	169	MAX FALL HEIGHT	144	

R5

FOR KIDS
AGES
5-12

This conceptual plan is based on information provided prior to construction. Detailed site information, including the following, should be obtained, evaluated, and utilized in the final project design. Exact site dimensions, topography, existing utilities, soil conditions and drainage solutions.

WARNING: Accessible safety surfacing material is required beneath and around this equipment that has a critical height value (Fall Height) appropriate for the highest accessible part of this equipment. Refer to the CPSC'S Handbook For Public Playground Safety, Section 4: Surfacing.

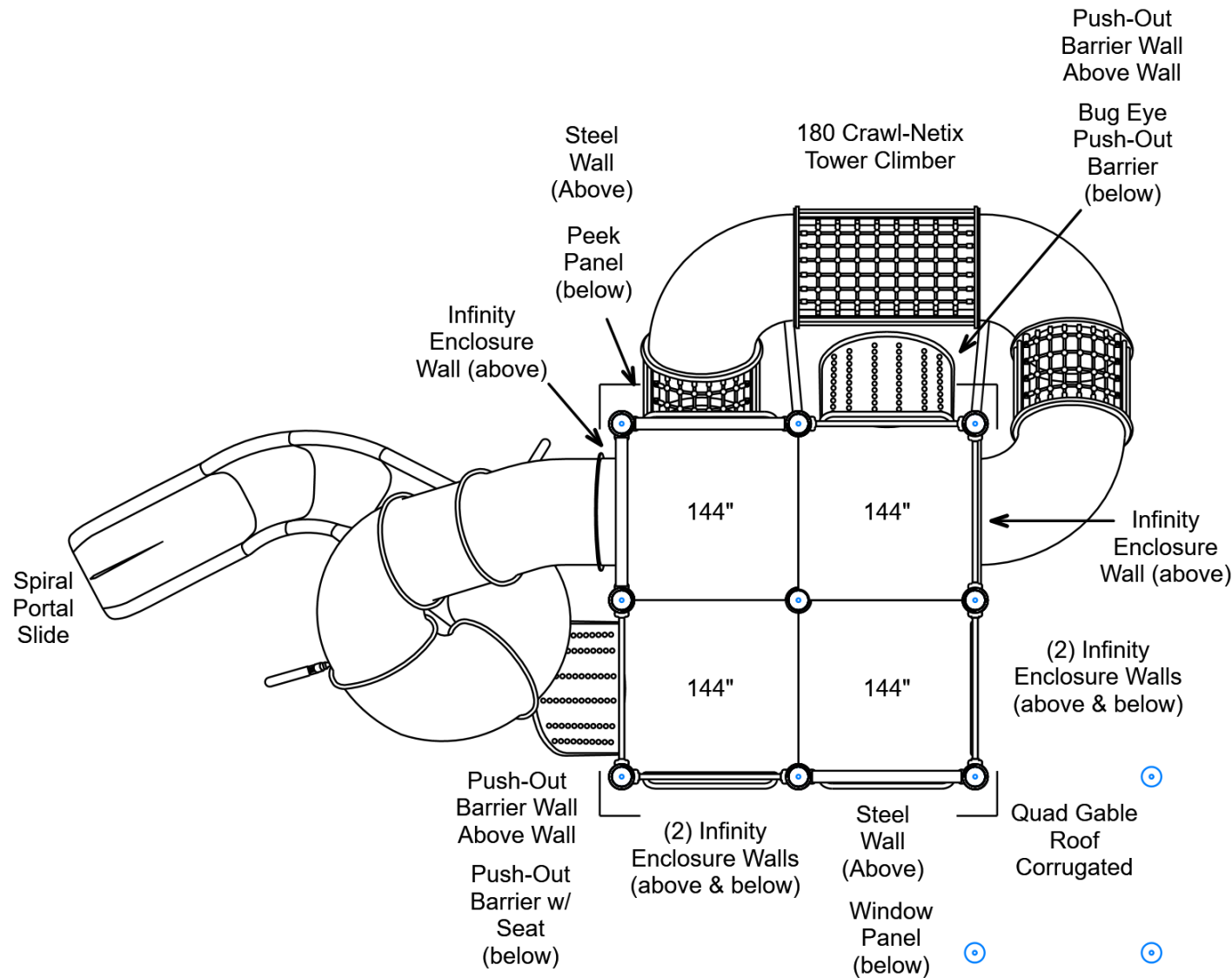

STRUCTURE # R502AE2FA
PROJECT # R502AE2FA
DATE 10/14/2024

Playcraft Direct, Inc.

MIN. USE ZONE 59' x 44' (17.971m x 13.389m)



R502AE2FA
SITE PLAN

ADA ACCESSIBILITY GUIDELINES - ADAAG CONFORMANCE

ELEVATED	ACCESSIBLE	RAMP ACCESSIBLE	GROUND	TYPES
11	9/6	0/0	11/4	4/3

R5

FOR KIDS
AGES
5-12

GENERAL NOTES

This Preliminary Site Plan is based on measurements that were provided in the initial planning phase. All dimensions must be verified prior to the submission of a purchase order. Playcraft Systems will not be held responsible for any discrepancies between actual dimensions and dimensions submitted in the planning phase.

The Minimum Use Zone for a play structure is based on the product design at the time of proposal. Components and structure designs may be subject to change which may affect dimensions. Therefore, before preparing the site, we strongly recommend obtaining final drawings from the factory (available after the order is placed and included in the Assembly Manual).

WARNING: Accessible safety surfacing material is required beneath and around this equipment that has a critical height value (Fall Height) appropriate for the highest accessible part of this equipment. Refer to the CPSC'S Handbook For Public Playground Safety, Section 4: Surfacing.

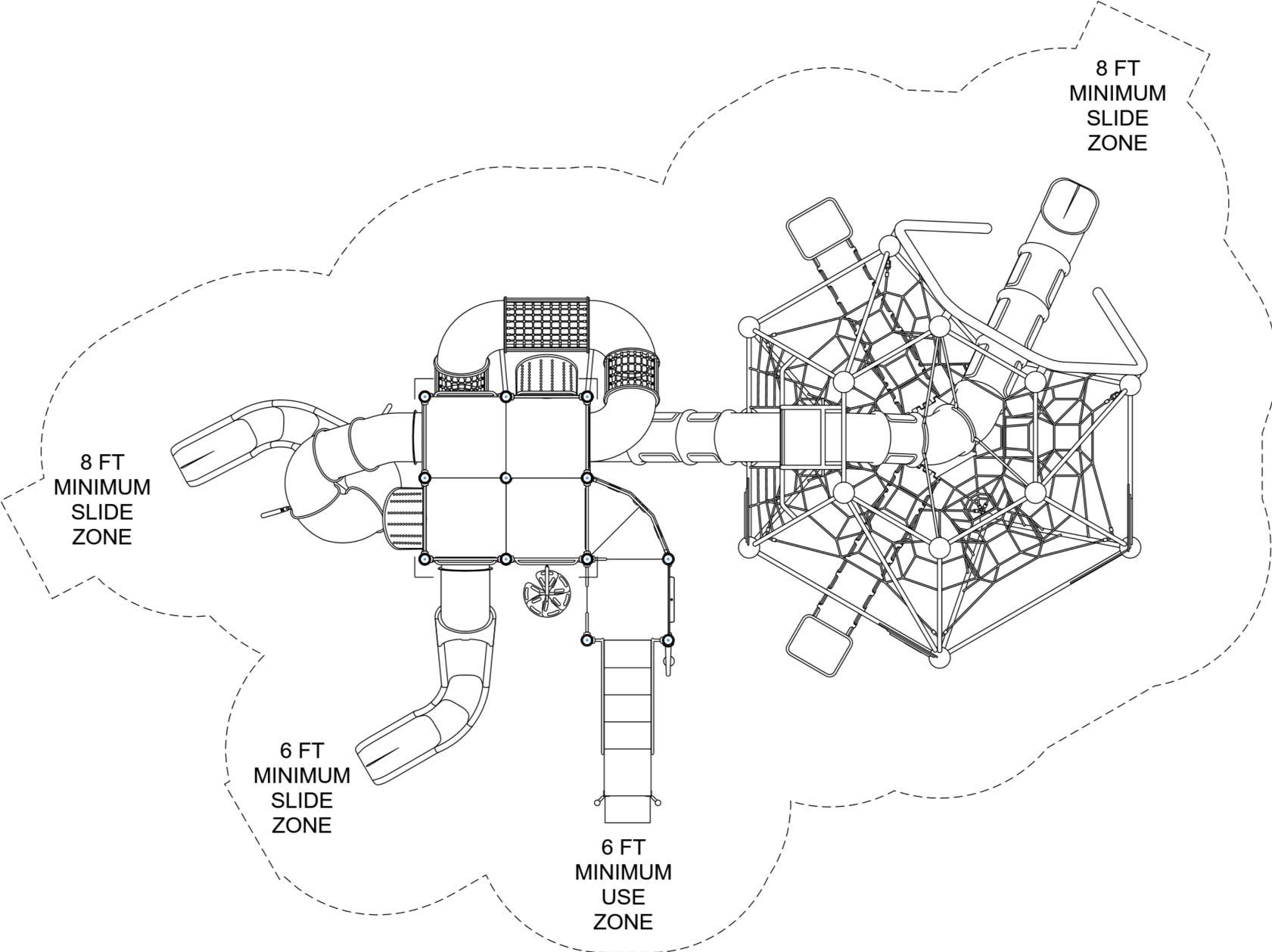

PROJECT # R502AE2FA
DATE 10/14/2024

Playcraft Direct, Inc.
MIN. USE ZONE 59' x 44' (17.983m x 13.411m)



R502AE2FA
SW VIEW

R5

FOR KIDS
AGES
5-12



STRUCTURE # R502AE2FA
PROJECT # R502AE2FA
DATE 10/14/2024

R502AE2FA
NE VIEW

R5

FOR KIDS
AGES
5-12

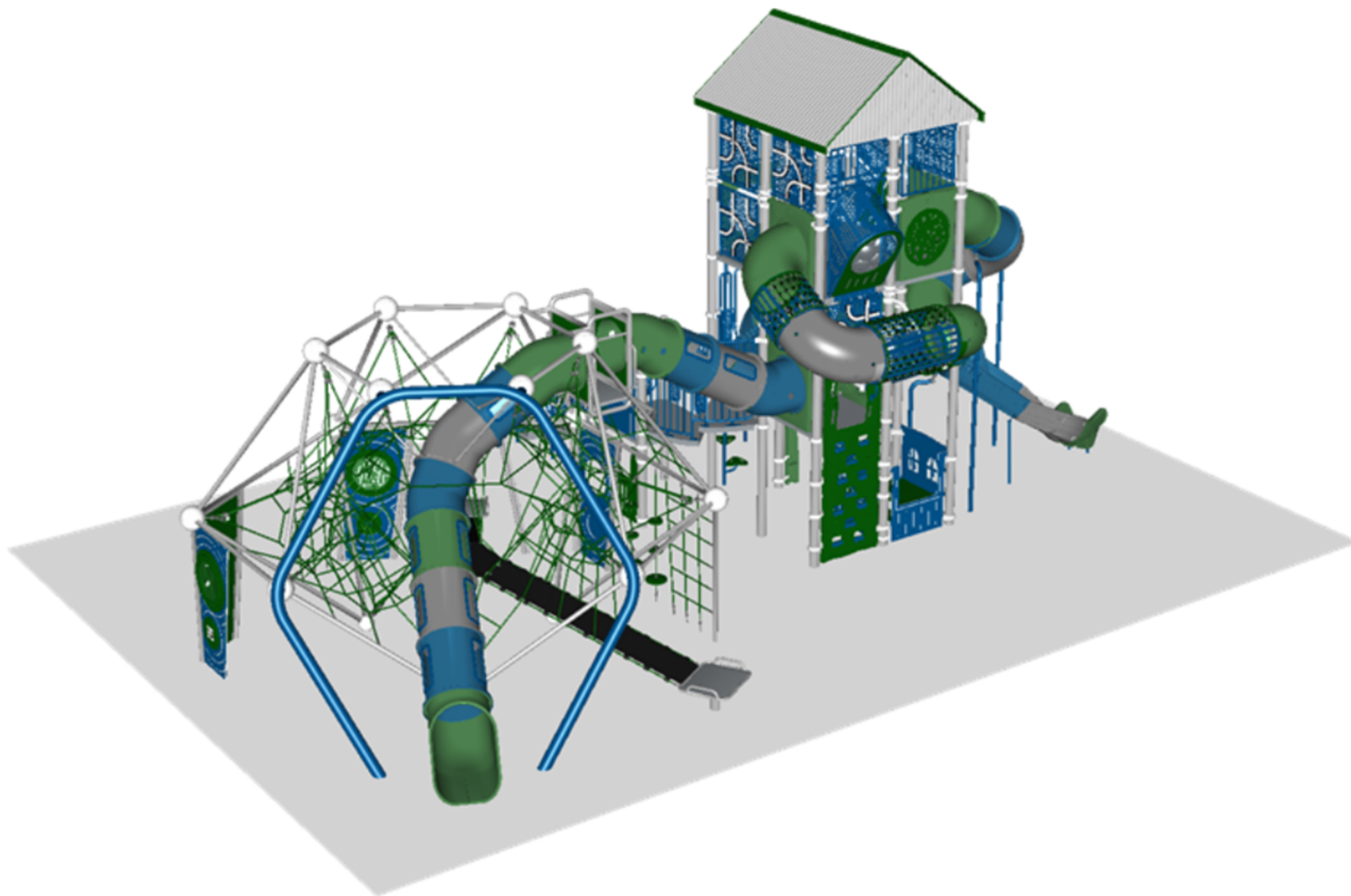

STRUCTURE # R502AE2FA
PROJECT # R502AE2FA
DATE 10/14/2024

R502AE2FA

Project # R502AE2FA

Date 10/14/2024

Item / Part Number	Description	Qty
[R502AE2FA]		
HS-1004-R	Collars	116
GF-7001	Flat Cap, R5	1
GF-7002	Dome Cap, R5	3
S-1011-R5-11ft	Post, 11ft R5	2
S-1012-R5-12ft	Post, 12ft R5	1
S-1016-R5F-9-144-183	Post, 16ft, 144in (183in)	1
S-1022-R5-22ft	Post, 22ft R5	8
S-1101-R5	Square Deck	8
S-11021-L	Spiral Deck, (Left, 24in)	1
S-1209-36IW	Infinity Transfer Station, 48in-C	1
S-1234-6R	Climber, Spiral Step 66-72in	1
S-1237-6R5	Climber, Vertical Rock 66-72in	1
S-1301-CGR1675	Push-Out Barrier (Above Wall, Corr. Roof)	1
S-1301-CGR3175-R5	Steel Wall (Above Panel, Corr. Roof)	2
S-1301-IU21	Wall, Infinity (Below Deck, Above Panel, 72)	6
S-1301-IUC3475	Wall, Infinity (Above Wall, Corr. Roof)	1
S-1301-IUD3175	Wall, Infinity (Above Panel, Steel Roof)	2
S-1301-IUD3475	Wall, Infinity (Above Wall, Steel Roof)	1
S-1301-IW	Wall, Infinity (Standard)	2
S-1301-RSSP1675	Push-Out Barrier (Above Wall, Double Bar)	1
S-1309-IW-R5	Infinity Half Walls (Pair)	1
S-1310-IW-R5	Infinity Transition Wall	1
S-1362-13112-R5	Push-Out Barrier (w/ Seat)	1
S-1362-16132-R5	Push-Out Barrier (Bug Eye)	1
S-1536-6R	Climber, Crawl-Netix Tower (180, Right)	1
S-1603-R5	Bubble Mirror Panel	1
S-1608-R5	Memory Panel	1
S-1610-R5	Peek Panel	1
S-1617-R5	Window Panel	1
S-1621-R17	House Panel	1
S-1639-R5	Clubhouse	1
S-1645-R5G	Store Panel (Open)	1
S-1653-R5	Door Panel (Tall Entry)	1
S-1661-R5	Panel Pal, Bell	1
S-1709-12SPR-LL	Slide, Portal 144in (Spiral, Left)	1
S-1709-6L-RR	Slide, Portal 72in (R-R, Right)	1

Item / Part Number	Description	Qty
S-18094-4R5	Metal Roof, Quad Gable (Corrugated)	1
S-8104-EP	Rope Rush Explorer Panel (Left)	1
S-8104-PP	Rope Rush Playful Panel (Right)	1
S-8104-TP	Rope Rush Thinker Panel (Left)	1
S-8112	Rope Rush Climb Wall (Left)	1
S-8120	Rope Rush Crawl-Tube Link	1
S-NE-8139	Rope Rush Astro Net	1