

R50249FBA TOP VIEW

ADA ACCESSIBILITY GUIDELINE - ADAAG CONFORMANCE

| ELEVATED | ACCESSIBLE | RAMP ACCESSIBLE | GROUND | TYPES |
|----------|------------|-----------------|--------|-------|
| 16 | 16/8 | 4 | 8/0 | 3/3 |

R5

FOR KIDS
AGES
2-5

GENERAL NOTES:

This conceptual plan is based on information provided prior to construction. Detailed site information, including the following, should be obtained, evaluated, and utilized in the final project design. Exact site dimensions, topography, existing utilities, soil conditions and drainage solutions.

WARNING: Accessible safety surfacing material is required beneath and around this equipment that has a critical height value (Fall Height) appropriate for the highest accessible part of this equipment. Refer to the CPSC'S Handbook For Public Playground Safety, Section 4: Surfacing.

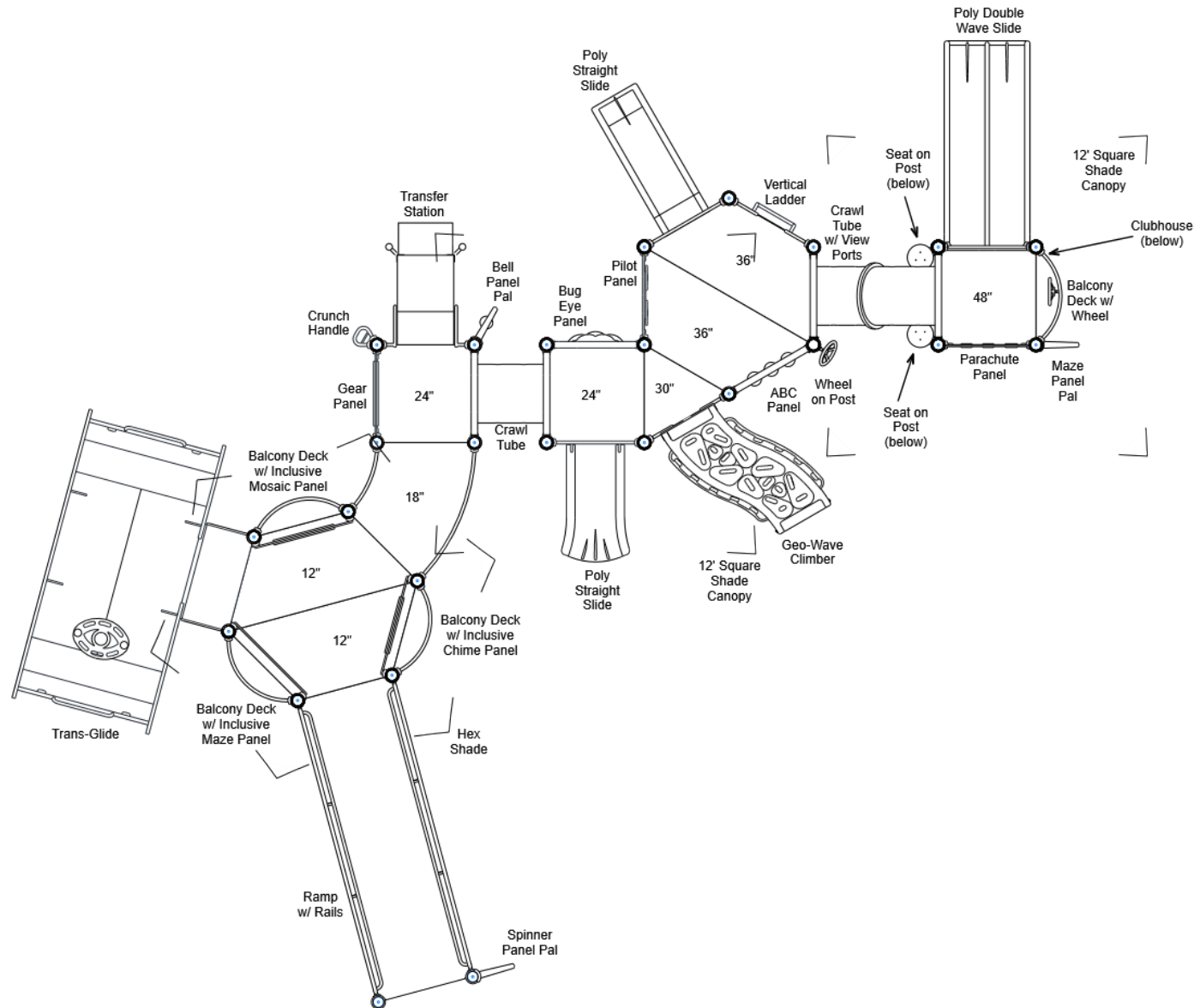

STRUCTURE#: R50249FBA

PROJECT#: R50249FBA

DATE: 12/30/2019 | DRAWN BY: Jefferson

MIN. USE ZONE: 53' x 45'

PLAYCRAFT REP:

Playcraft Direct, Inc.



R50249FBA SITE PLAN

ADA ACCESSIBILITY GUIDELINE - ADAAG CONFORMANCE

| ELEVATED | ACCESSIBLE | RAMP ACCESSIBLE | GROUND | TYPES |
|----------|------------|-----------------|--------|-------|
| 16 | 16/8 | 4 | 8/0 | 3/3 |



GENERAL NOTES:

This Preliminary Site Plan is based on measurements that were provided in the initial planning phase. All dimensions must be verified prior to the submission of a purchase order. Playcraft Systems will not be held responsible for any discrepancies between actual dimensions and dimensions submitted in the planning phase.

The Minimum Use Zone for a play structure is based on the product design at the time of proposal. Components and structure designs may be subject to change which may affect dimensions. Therefore, before preparing the site, we strongly recommend obtaining final drawings from the factory (available after the order is placed and included in the Assembly Manual).

WARNING: Accessible safety surfacing material is required beneath and around this equipment that has a critical height value (Fall Height) appropriate for the highest accessible part of this equipment. Refer to the CPSC's Handbook For Public Playground Safety, Section 4: Surfacing.

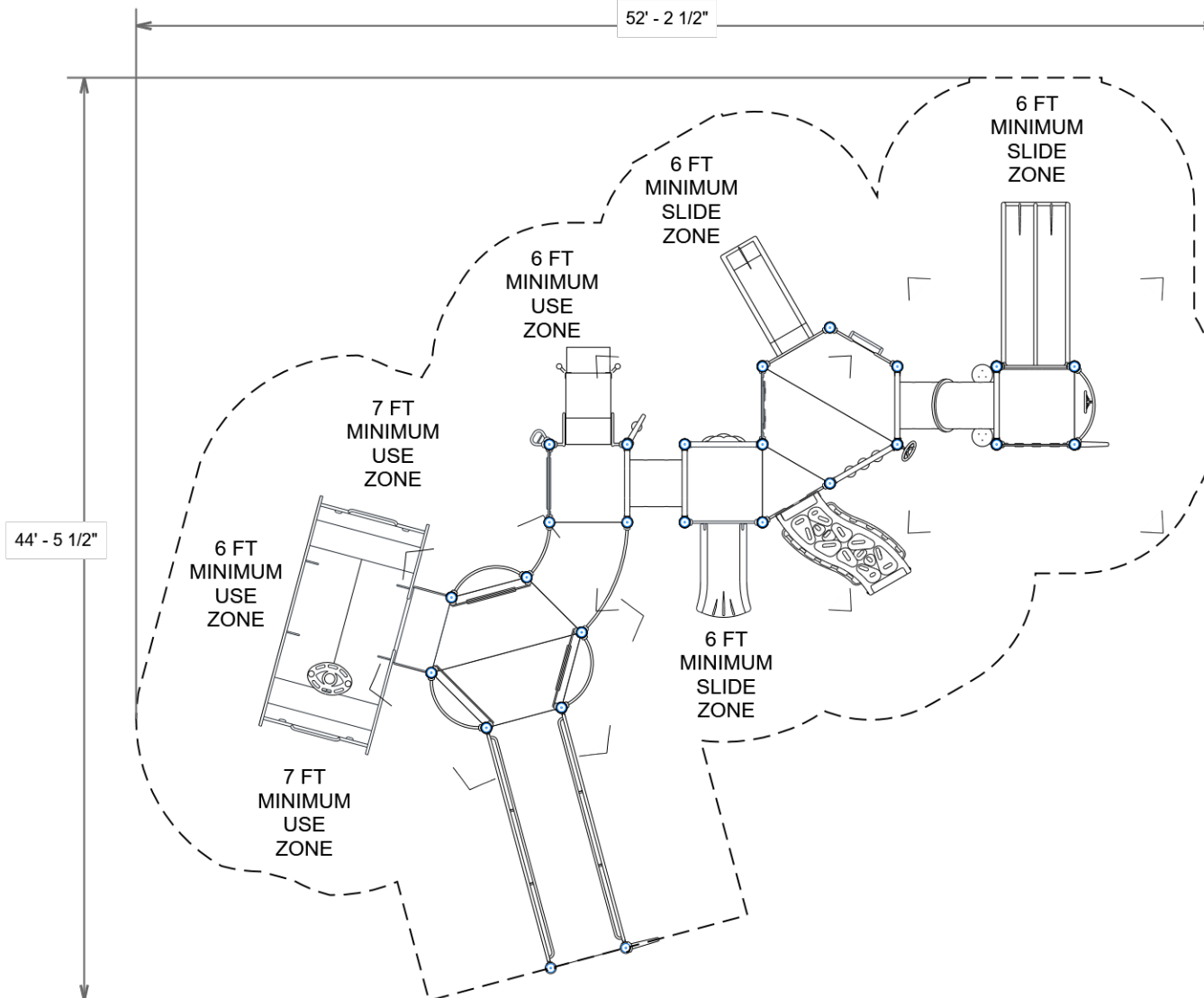

PROJECT#: R50249FBA

DATE: 12/30/2019 | DRAWN BY: Jefferson

MIN. USE ZONE: 53' x 45'

PLAYCRAFT REP:

Playcraft Direct, Inc.



R50249FBA
SW VIEW

R5

FOR KIDS
AGES
2-5

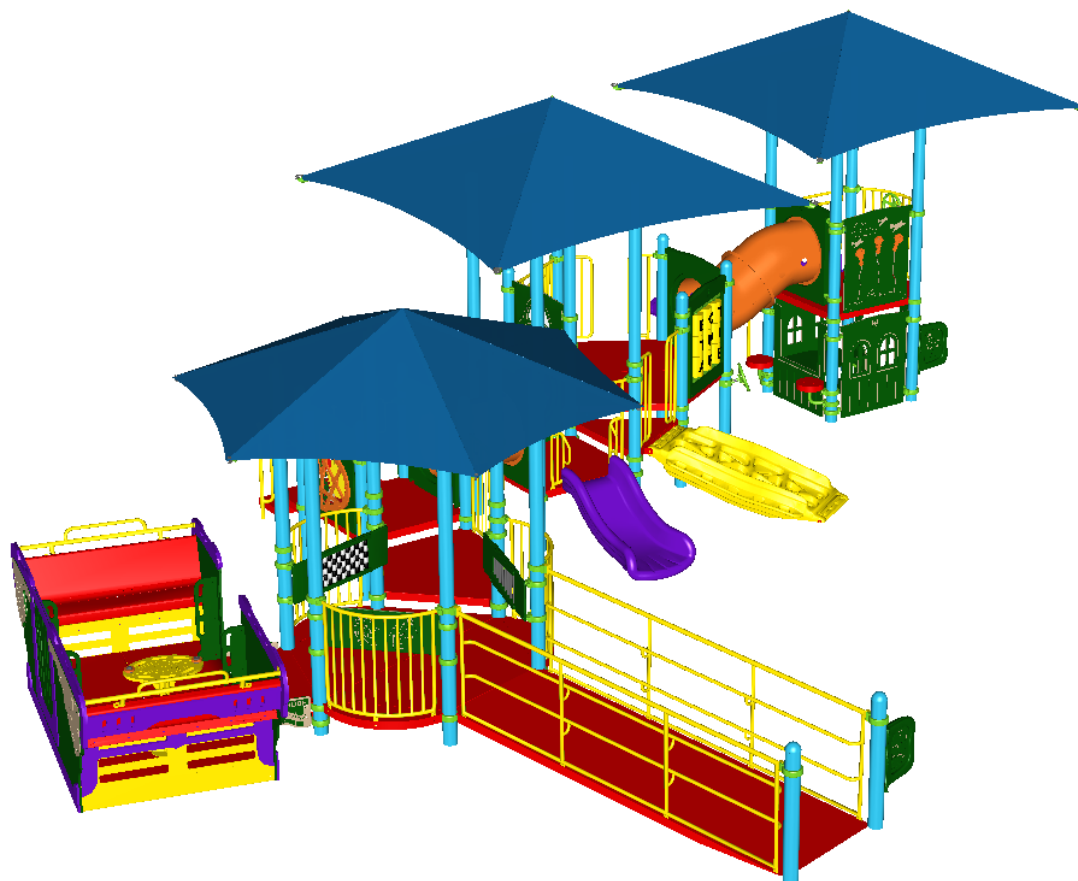

STRUCTURE#: R50249FBA
PROJECT#: R50249FBA
DATE: 12/30/2019 | DRAWN BY: Jefferson

R50249FBA
NE VIEW

R5

FOR KIDS
AGES
2-5

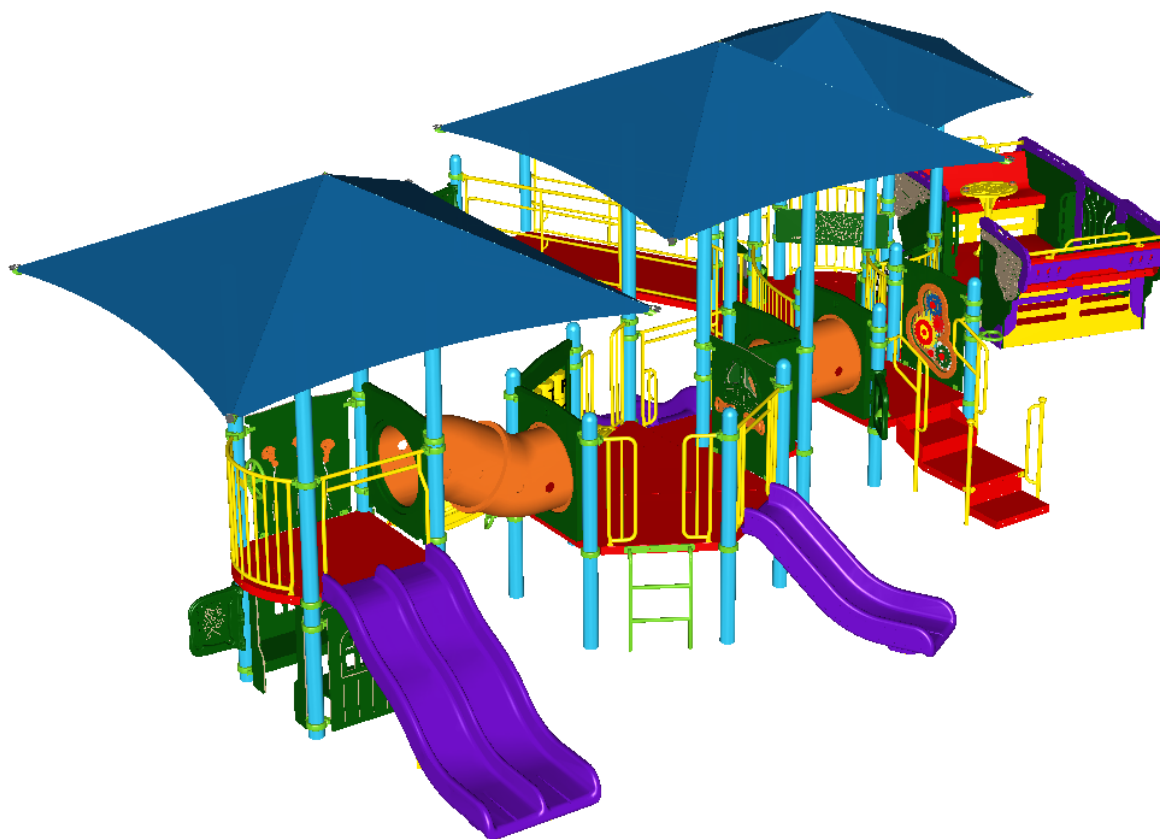

STRUCTURE#: R50249FBA
PROJECT#: R50249FBA
DATE: 12/30/2019 | DRAWN BY: Jefferson



Bill of Materials

R50249FBA

Project# R50249FBA

12/30/2019

| Item | Description | Quantity |
|-----------------|---|----------|
| R50249FBA | | |
| HS-1004-R | Collars | 98 |
| GF-7002 | Dome Cap, R5 | 11 |
| S-1007-R5-07ft | Post, 07ft R5 | 2 |
| S-1009-R5-09ft | Post, 09ft R5 | 4 |
| S-1010-R5-10ft | Post, 10ft R5 | 5 |
| S-1013-R5-13ft | Post, 13ft R5 | 6 |
| S-1015-R5-15ft | Post, 15ft R5 | 8 |
| S-1101-R5 | Square Deck | 3 |
| S-1102-R5 | Tri-Deck | 1 |
| S-1106-R5 | Hex Deck, Half (4 Post) | 4 |
| S-1109-R5 | Balcony Deck | 3 |
| S-1109-R5-MT | Balcony Deck w/ Wheel | 1 |
| S-1208-R-RAIL12 | Ramp 144in (Ground w/ Rails, Inclined) | 1 |
| S-1209-12-R5 | Transfer Station, 24in-C | 1 |
| S-1210-36 | Climber, Vertical Ladder 30-36in | 1 |
| S-1249-DGH | Climber, Incl. Geo-Wave 30-36in (Horiz, DTG Left) | 1 |
| S-1304-R5 | Single Slide SitDown Wall | 1 |
| S-1305-R5 | Double Slide SitDown Wall | 1 |
| S-1309-2-R5 | Half Walls (Pair) R5 | 2 |
| S-1500-2I-R5 | Crawl Tube, 12 Inclined (2-Section) | 1 |
| S-1500-32-R5 | Crawl Tube, 32in | 1 |
| S-1511-R5 | Bridge, Curved | 1 |
| S-1619-R5 | ABC Panel | 1 |
| S-1632-R5 | Bug Eye Panel | 1 |
| S-1639-R5 | Clubhouse | 1 |



Bill of Materials (continued)

| Item | Description | Quantity |
|--------------|----------------------------------|----------|
| S-16431-R5 | Parachute Panel | 1 |
| S-1643-R5 | Pilot Panel | 1 |
| S-1644-R5 | Gear Panel | 1 |
| S-1661-R5 | Panel Pal, Bell | 1 |
| S-1663-R5 | Panel Pal, Maze | 1 |
| S-1666-R5 | Panel Pal, Spinner | 1 |
| S-1686-R5 | Inclusive Panel, Mosaic | 1 |
| S-1687-R5 | Inclusive Panel, Chime | 1 |
| S-1688-R5 | Inclusive Panel, Maze | 1 |
| S-1701-2R5V2 | Slide, Single 24-30in (Straight) | 1 |
| S-1701-3 | Slide, Single 36in (Straight) | 1 |
| S-1702-4R5 | Slide, Wave 48in (Double) | 1 |
| S-18021-12R5 | Shade Canopy, 12ft Square | 2 |
| S-18026-R5 | Shade Canopy, Hex | 1 |
| S-1812-R5 | Driver Wheel (Post Mounted) | 1 |
| S-1937-R5 | Crunch Handle | 1 |
| S-1963-R5 | Seat on Post | 2 |
| S-1975-R5 | Trans-Glide | 1 |
| HS-1100-3 | Deck to Deck Hardware | 3 |