

R35E0C2EA

TOP VIEW

## ADA ACCESSIBILITY GUIDELINES - ADAAG CONFORMANCE

ELEVATED	ACCESSIBLE	RAMP ACCESSIBLE	GROUND	TYPES
11	6/6	0/0	5/4	3/3
CHILD CAPACITY	97	MAX FALL HEIGHT	84	

R35

FOR KIDS  
AGES  
5-12

## GENERAL NOTES

This conceptual plan is based on information provided prior to construction. Detailed site information, including the following, should be obtained, evaluated, and utilized in the final project design. Exact site dimensions, topography, existing utilities, soil conditions and drainage solutions.

WARNING: Accessible safety surfacing material is required beneath and around this equipment that has a critical height value (Fall Height) appropriate for the highest accessible part of this equipment. Refer to the CPSC'S Handbook For Public Playground Safety, Section 4: Surfacing.

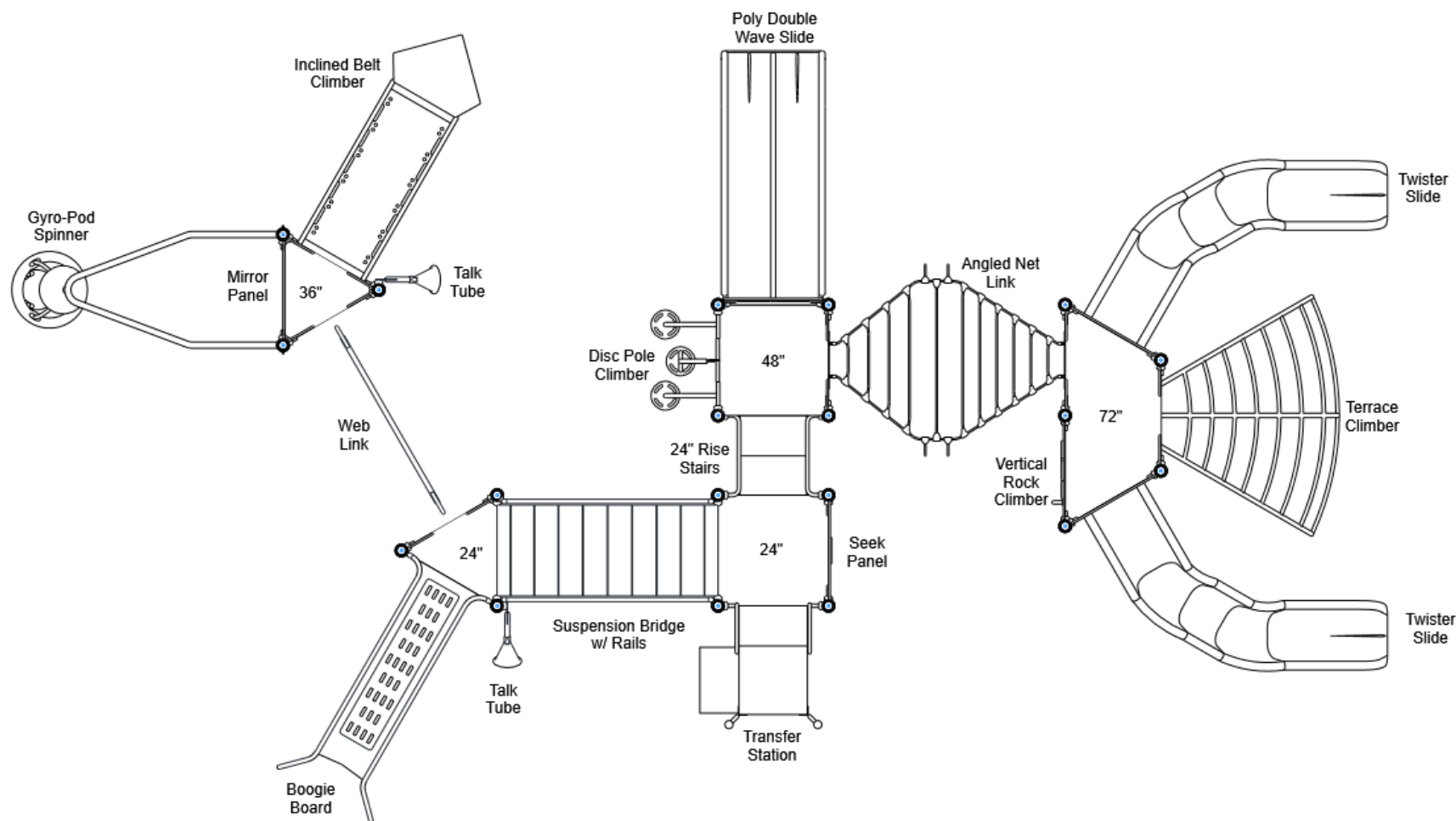

STRUCTURE # R35E0C2EA  
PROJECT # R35E0C2EA  
DATE 8/25/2023

Playcraft Direct, Inc.

MIN. USE ZONE 56' x 37' (16.943m x 11.253m)

# R35E0C2EA SITE PLAN

## ADA ACCESSIBILITY GUIDELINES - ADAAG CONFORMANCE

ELEVATED	ACCESSIBLE	RAMP ACCESSIBLE	GROUND	TYPES
12	10/6	0/0	3/4	1/3

**R35**

FOR KIDS  
AGES  
5-12

### GENERAL NOTES

This Preliminary Site Plan is based on measurements that were provided in the initial planning phase. All dimensions must be verified prior to the submission of a purchase order. Playcraft Systems will not be held responsible for any discrepancies between actual dimensions and dimensions submitted in the planning phase.

The Minimum Use Zone for a play structure is based on the product design at the time of proposal. Components and structure designs may be subject to change which may affect dimensions. Therefore, before preparing the site, we strongly recommend obtaining final drawings from the factory (available after the order is placed and included in the Assembly Manual).

**WARNING:** Accessible safety surfacing material is required beneath and around this equipment that has a critical height value (Fall Height) appropriate for the highest accessible part of this equipment. Refer to the CPSC'S Handbook For Public Playground Safety, Section 4: Surfacing.

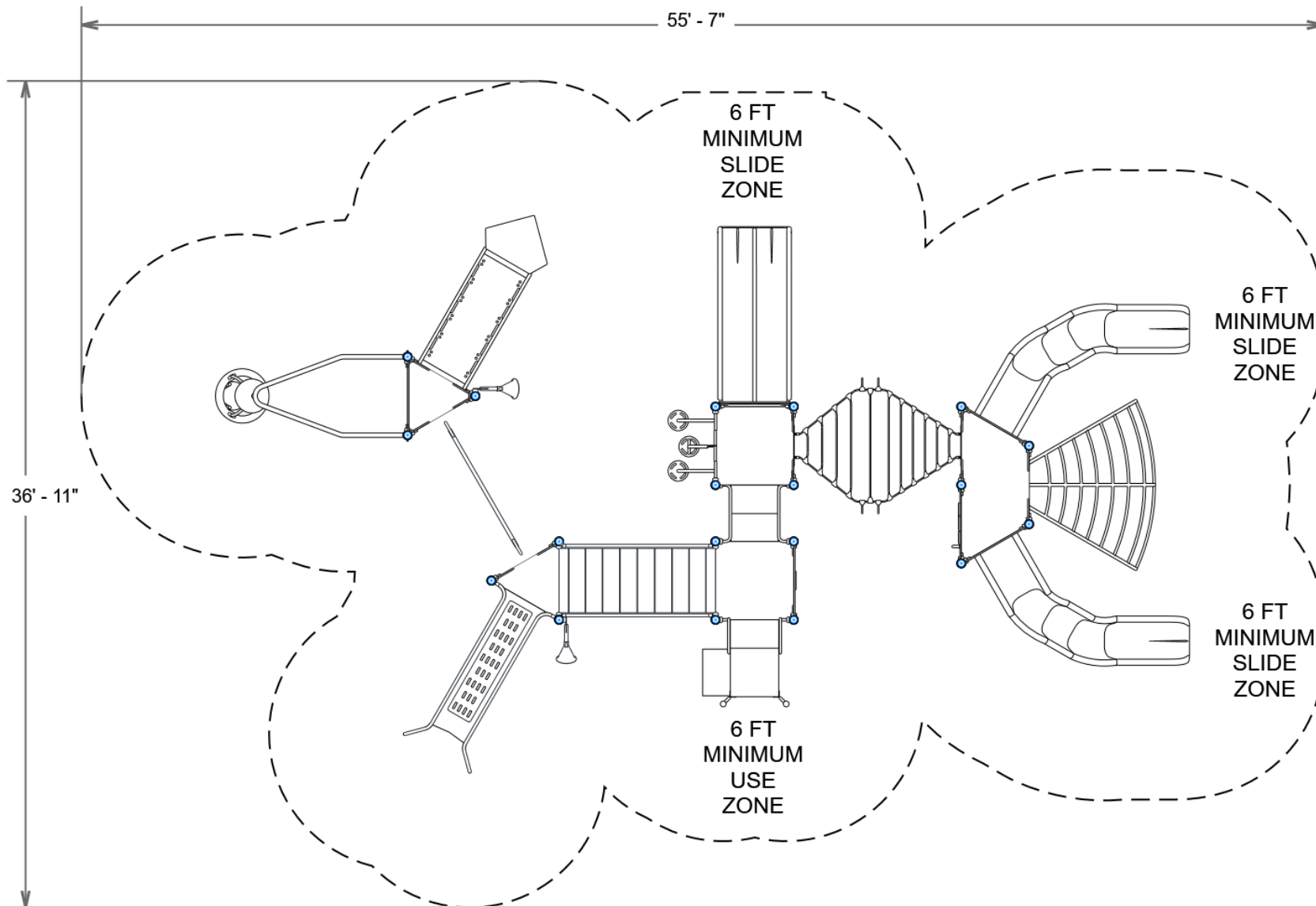

PROJECT #  
DATE

R35E0C2EA  
8/25/2023

**Playcraft Direct, Inc.**

MIN. USE ZONE 56' x 37' (16.943m x 11.253m)



**R35E0C2EA**  
**SW VIEW**

**R35**

FOR KIDS  
AGES  
5-12

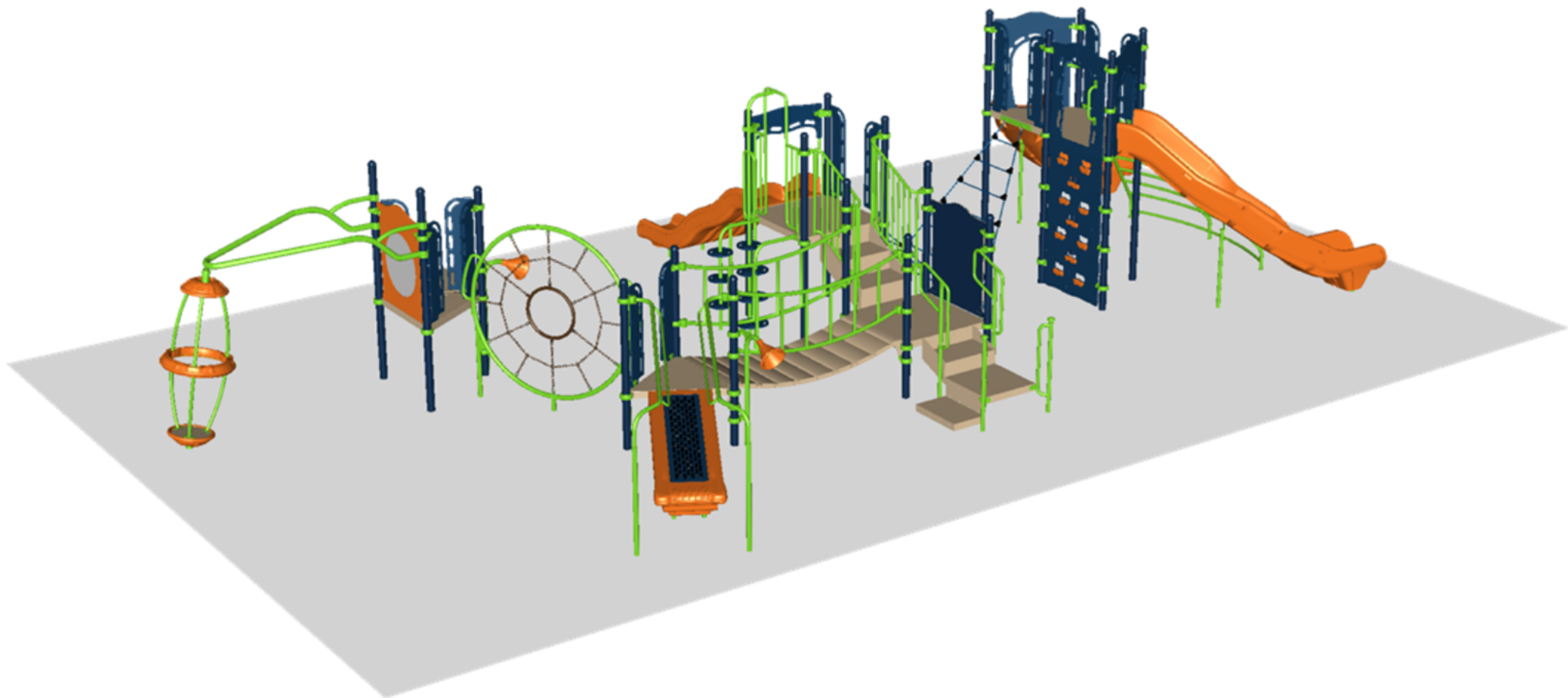

**STRUCTURE #** R35E0C2EA  
**PROJECT #** R35E0C2EA  
**DATE** 8/25/2023

**R35E0C2EA**  
**NE VIEW**

**R35**

FOR KIDS  
AGES  
5-12

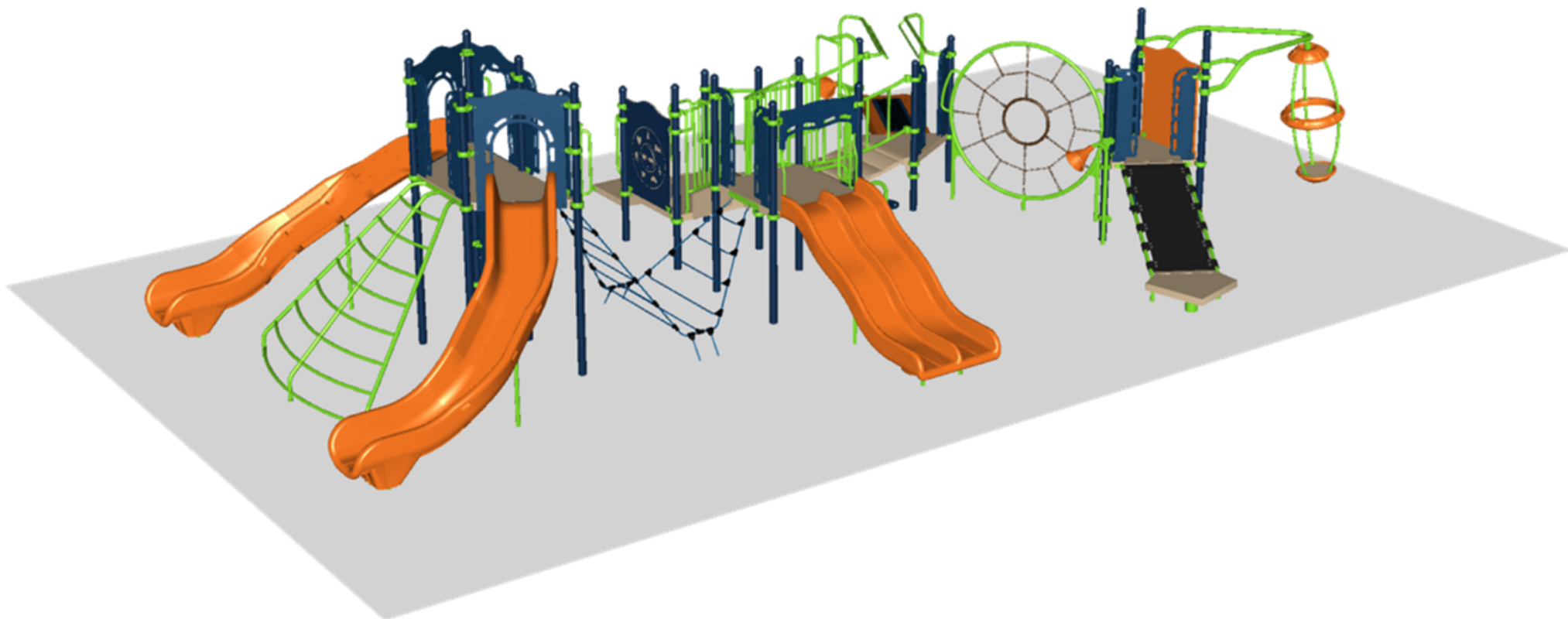

**STRUCTURE #** R35E0C2EA  
**PROJECT #** R35E0C2EA  
**DATE** 8/25/2023

**R35E0C2EA**
**Project #** R35E0C2EA

**Date** 8/25/2023

Item / Part Number	Description	Qty
<b>[R35E0C2EA]</b>		
HS-1004-R35	Collars	65
A2-1517	Link, Web	1
GG-8135	Dome Cap, R3.5	19
S-1009-R35-09ft	Post, 09ft R3.5	5
S-1010-R35-10ft	Post, 10ft R3.5	3
S-1011-R35-11ft	Post, 11ft R3.5	6
S-1013-R35-13ft	Post, 13ft R3.5	5
S-1101-R35	Square Deck	2
S-1102-R35	Tri-Deck	2
S-1103-R35	Hex Deck, Half (5 Post)	1
S-1206-24R35	ADA Stairs, 24in Rise w/ Walls	1
S-1209-12-R35	Transfer Station, 24in-L	1
S-12091-3	Climber, Inc. Belt 36in (Dual Access)	1
S-1237-6R35	Climber, Vertical Rock 66-72in	1
S-1240-6	Climber, Terrace 66-72in	1
S-1243-4	Climber, Disc Pole 42-48in	1
S-1309-2-R35	Half Walls (Pair) R35	4
S-1310-R35	Transition Wall	1
S-1316-R35	Twister Entry Panel	2
S-1506-R-84R35	Bridge, Suspension w/ Rails	1
S-1528-R35	Link, Angled Net (90in)	1
S-1609-R35	Mirror Panel	1
S-1618-R35	Seek Panel (Standard)	1
S-1702-4R35	Slide, Wave 48in (Double)	1
S-1710-6-LSL	Slide, Twister 72in (L-S-L)	1
S-1710-6-RSR	Slide, Twister 72in (R-S-R)	1
S-1910-R35	Talk Tube (Post Mounted, Left)	2
S-1941-R35	Boogie Board	1
S-1974-R35	Gyro-Pod Spinner	1