

R35DB9EEA

TOP VIEW

ADA ACCESSIBILITY GUIDELINE - ADAAG CONFORMANCE

ELEVATED	ACCESSIBLE	RAMP ACCESSIBLE	GROUND	TYPES
13	8/7	0	4/4	3/3

R35

FOR KIDS
AGES
5-12

GENERAL NOTES:

This conceptual plan is based on information provided prior to construction. Detailed site information, including the following, should be obtained, evaluated, and utilized in the final project design. Exact site dimensions, topography, existing utilities, soil conditions and drainage solutions.

WARNING: Accessible safety surfacing material is required beneath and around this equipment that has a critical height value (Fall Height) appropriate for the highest accessible part of this equipment. Refer to the CPSC's Handbook For Public Playground Safety, Section 4: Surfacing.

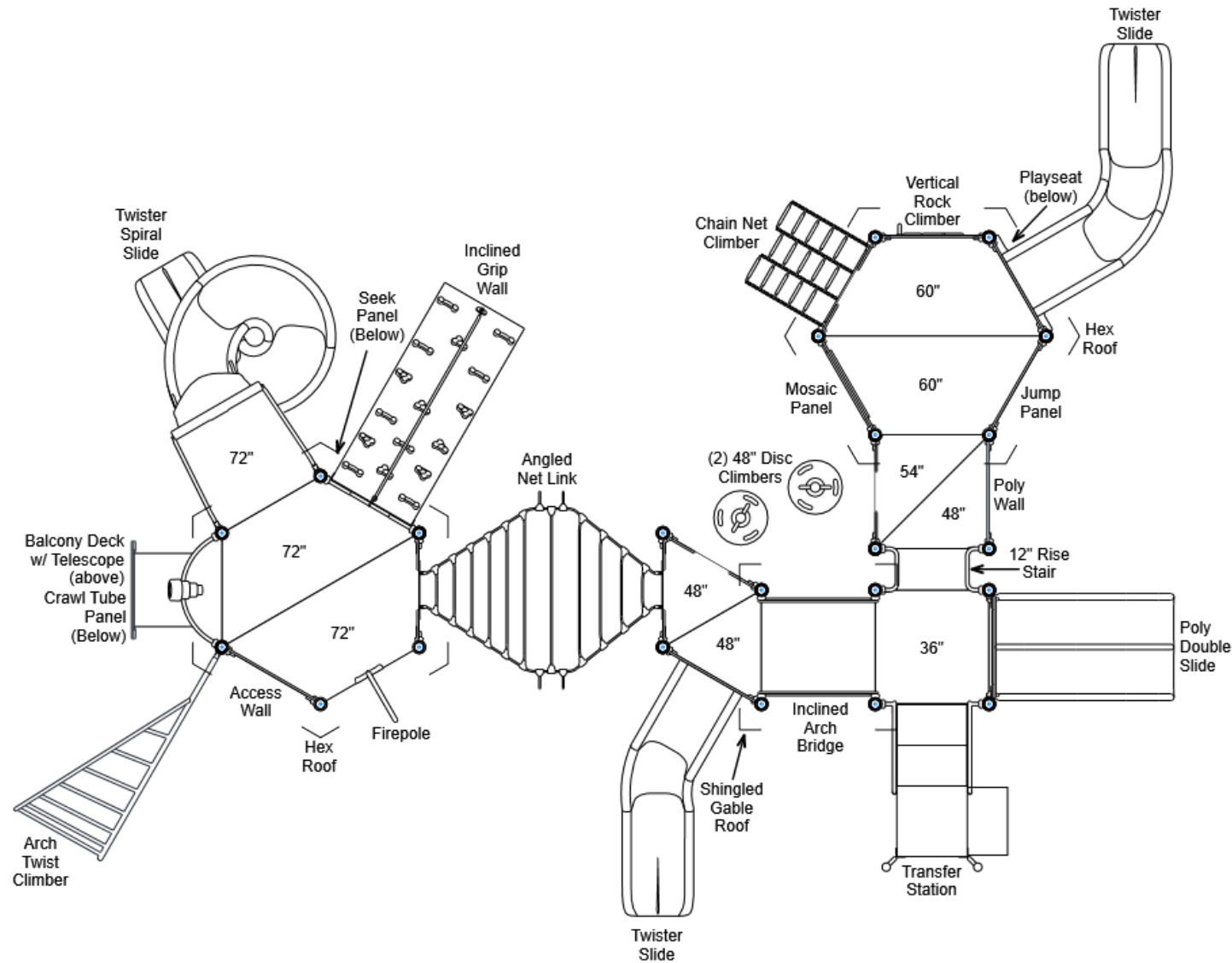

STRUCTURE#: R35DB9EEA

PROJECT#: R35DB9EEA

DATE: 1/6/2021 | DRAWN BY: Alyssa

MIN. USE ZONE: 48' x 39'

PLAYCRAFT REP:

Playcraft Direct, Inc.

R35DB9EEA
SITE PLAN

ADA ACCESSIBILITY GUIDELINE - ADAAG CONFORMANCE

ELEVATED	ACCESSIBLE	RAMP ACCESSIBLE	GROUND	TYPES
13	8/7	0	4/4	3/3

R35

FOR KIDS
AGES
5-12

GENERAL NOTES:

This Preliminary Site Plan is based on measurements that were provided in the initial planning phase. All dimensions must be verified prior to the submission of a purchase order. Playcraft Systems will not be held responsible for any discrepancies between actual dimensions and dimensions submitted in the planning phase.

The Minimum Use Zone for a play structure is based on the product design at the time of proposal. Components and structure designs may be subject to change which may affect dimensions. Therefore, before preparing the site, we strongly recommend obtaining final drawings from the factory (available after the order is placed and included in the Assembly Manual).

WARNING: Accessible safety surfacing material is required beneath and around this equipment that has a critical height value (Fall Height) appropriate for the highest accessible part of this equipment. Refer to the CPSC's Handbook For Public Playground Safety, Section 4: Surfacing.

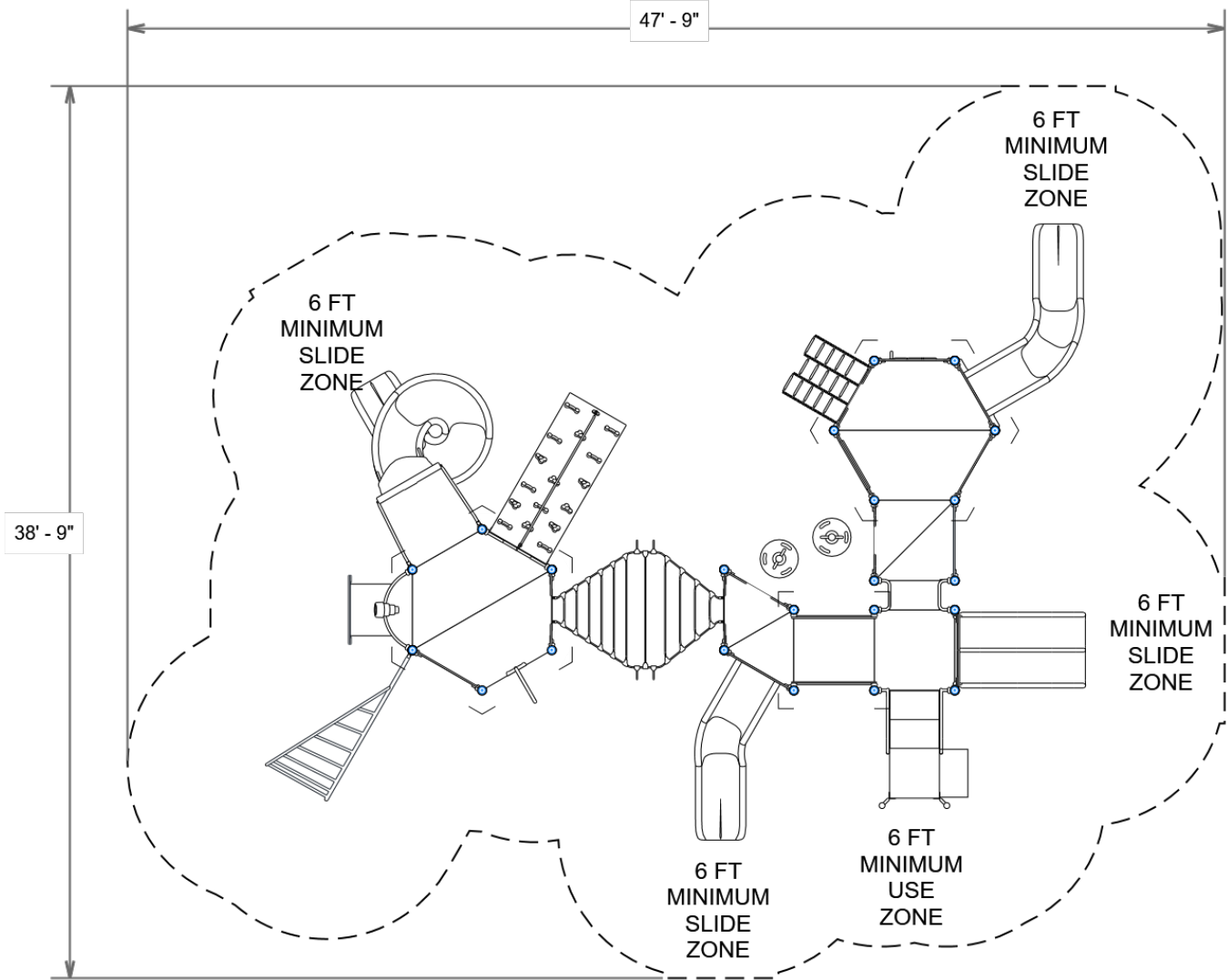

PROJECT#: R35DB9EEA
DATE: 1/6/2021 | DRAWN BY: Alyssa

MIN. USE ZONE: 48' x 39'

PLAYCRAFT REP:
Playcraft Direct, Inc.

R35DB9EEA
SW VIEW

R35

FOR KIDS
AGES
5-12



STRUCTURE#: R35DB9EEA

PROJECT#: R35DB9EEA

DATE: 1/6/2021 | DRAWN BY: Alyssa

R35DB9EEA
NE VIEW

R35

FOR KIDS
AGES
5-12



STRUCTURE#: R35DB9EEA

PROJECT#: R35DB9EEA

DATE: 1/6/2021 | DRAWN BY: Alyssa



Bill of Materials

R35DB9EEA

Project# R35DB9EEA

1/6/2021

Item	Description	Quantity
R35DB9EEA		
HS-1004-R35	Collars	74
GG-8135	Dome Cap, R3.5	6
S-1010-R35-10ft	Post, 10ft R3.5	1
S-1011-R35-11ft	Post, 11ft R3.5	4
S-1012-R35-12ft	Post, 12ft R3.5	1
S-1014-R35-14ft	Post, 14ft R3.5	4
S-1015-R35-15ft	Post, 15ft R3.5	6
S-1016-R35-16ft	Post, 16ft R3.5	6
S-1101-R35	Square Deck	1
S-1102-R35	Tri-Deck	2
S-1105-R35	Half Deck	2
S-1106-R35	Hex Deck, Half (4 Post)	4
S-1109-R35-T	Balcony Deck w/ Telescope	1
S-1206-12R35	ADA Stairs, 12in Rise w/ Walls	1
S-1209-24-R35	Transfer Station, 36in-R	1
S-1213-6R35	Climber, Firepole 66-72in	1
S-1215-6	Climber, Inc. Grip Wall 72in	1
S-1221-5	Climber, Chain Net 54-60in	1
S-1233-4-MC	Climber, Disc 42-48in	2
S-1237-5R35	Climber, Vertical Rock 54-60in	1
S-1281-L-6R35	Climber, Arch Twist 72in (Left)	1
S-1301-R35	Poly Wall (Standard)	1
S-1309-2-R35	Half Walls (Pair) R35	3
S-1310-R35	Transition Wall	1
S-1314-R35L	Access Wall (Left)	1



Bill of Materials (continued)

Item	Description	Quantity
S-1316-R35	Twister Entry Panel	2
S-1514-R35	Bridge, Inclined Arch	1
S-1528-R35	Link, Angled Net (90in)	1
S-1618-R35I	Seek Panel	1
S-1620-R35	Jump Panel	1
S-16801-R35I	Crawl Tube Panel	1
S-1685-R35	Mosaic Panel	1
S-1702-3R35	Slide, Double 36in	1
S-1706-S6R-R35	Slide, Twister Spiral 72 (R)	1
S-1710-4-L	Slide, Twister 48in (L)	1
S-1710-5-LL	Slide, Twister 60in (L2)	1
S-1803-R35	Roof, Hex	2
S-1808-R35	Roof, Gable (Shingled)	1
S-1962-R35	Playseat (Double Post)	1
HS-1100-2	Deck to Deck Hardware	3