

R3567FE4C TOP VIEW

ADA ACCESSIBILITY GUIDELINE - ADAAG CONFORMANCE

ELEVATED	ACCESSIBLE	RAMP ACCESSIBLE	GROUND	TYPES
11	10/6	0	6/4	3/3

R35

FOR KIDS
 AGES
 5-12

GENERAL NOTES:

This conceptual plan is based on information provided prior to construction. Detailed site information, including the following, should be obtained, evaluated, and utilized in the final project design. Exact site dimensions, topography, existing utilities, soil conditions and drainage solutions.

WARNING: Accessible safety surfacing material is required beneath and around this equipment that has a critical height value (Fall Height) appropriate for the highest accessible part of this equipment. Refer to the CPSC'S Handbook For Public Playground Safety, Section 4: Surfacing.

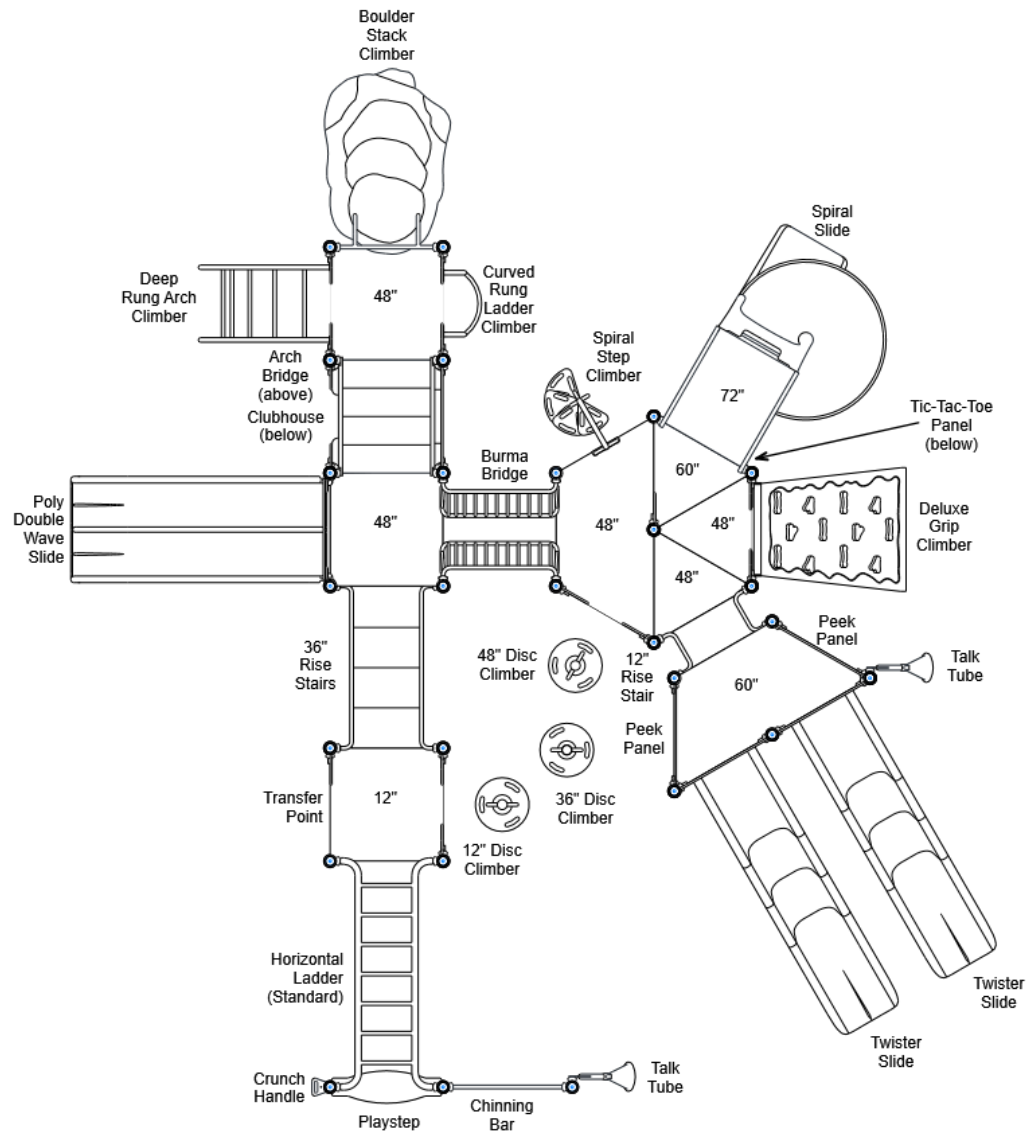

STRUCTURE#: R3567FE4C

PROJECT#: R3567FE4C

DATE: 4/21/2020 | DRAWN BY: Derick

MIN. USE ZONE: 41' x 45'

PLAYCRAFT REP:

Playcraft Direct, Inc.



R3567FE4C SITE PLAN

ADA ACCESSIBILITY GUIDELINE - ADAAG CONFORMANCE

ELEVATED	ACCESSIBLE	RAMP ACCESSIBLE	GROUND	TYPES
11	10/6	0	6/4	3/3



GENERAL NOTES:

This Preliminary Site Plan is based on measurements that were provided in the initial planning phase. All dimensions must be verified prior to the submission of a purchase order. Playcraft Systems will not be held responsible for any discrepancies between actual dimensions and dimensions submitted in the planning phase.

The Minimum Use Zone for a play structure is based on the product design at the time of proposal. Components and structure designs may be subject to change which may affect dimensions. Therefore, before preparing the site, we strongly recommend obtaining final drawings from the factory (available after the order is placed and included in the Assembly Manual).

WARNING: Accessible safety surfacing material is required beneath and around this equipment that has a critical height value (Fall Height) appropriate for the highest accessible part of this equipment. Refer to the CPSC'S Handbook For Public Playground Safety, Section 4: Surfacing.

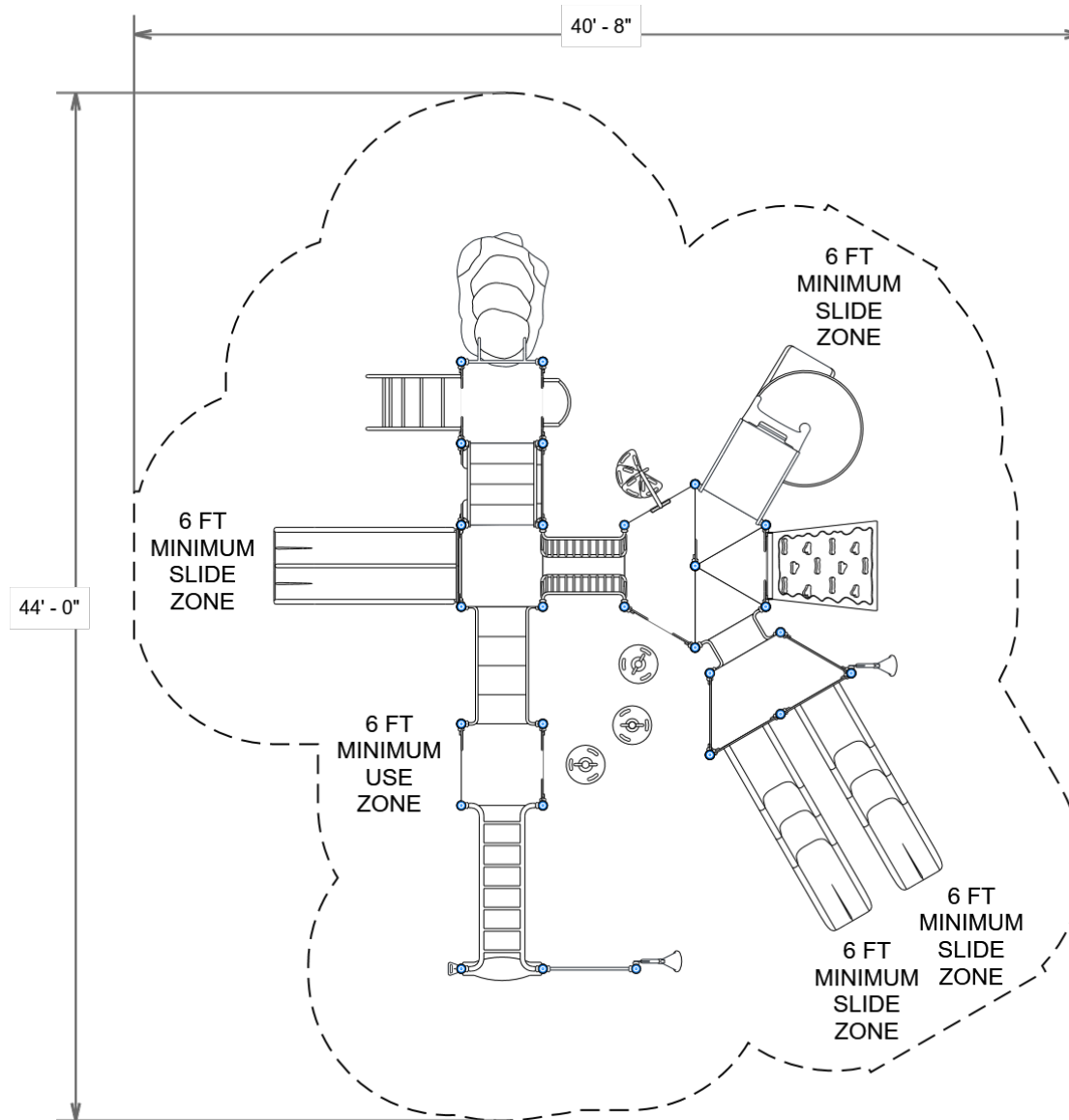

PROJECT#: R3567FE4C

DATE: 4/21/2020 | DRAWN BY: Derick

MIN. USE ZONE: 41' x 45'

PLAYCRAFT REP:

Playcraft Direct, Inc.



R3567FE4C
SW VIEW

R35

FOR KIDS
AGES
5-12

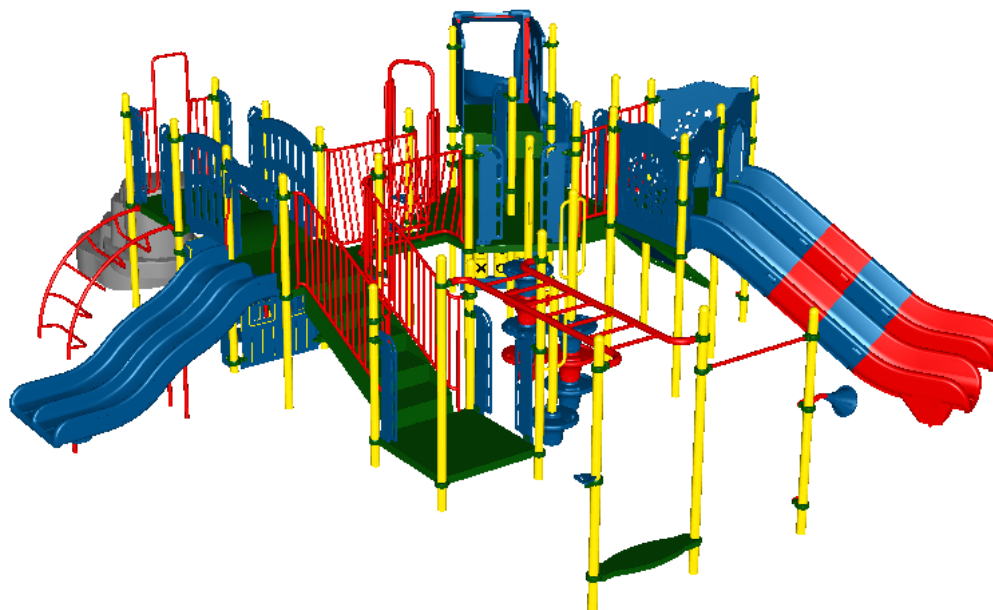

STRUCTURE#: R3567FE4C

PROJECT#: R3567FE4C

DATE: 4/21/2020 | DRAWN BY: Derick

PLAYCRAFT
SYSTEMS

R3567FE4C
NE VIEW

R35

FOR KIDS
AGES
5-12

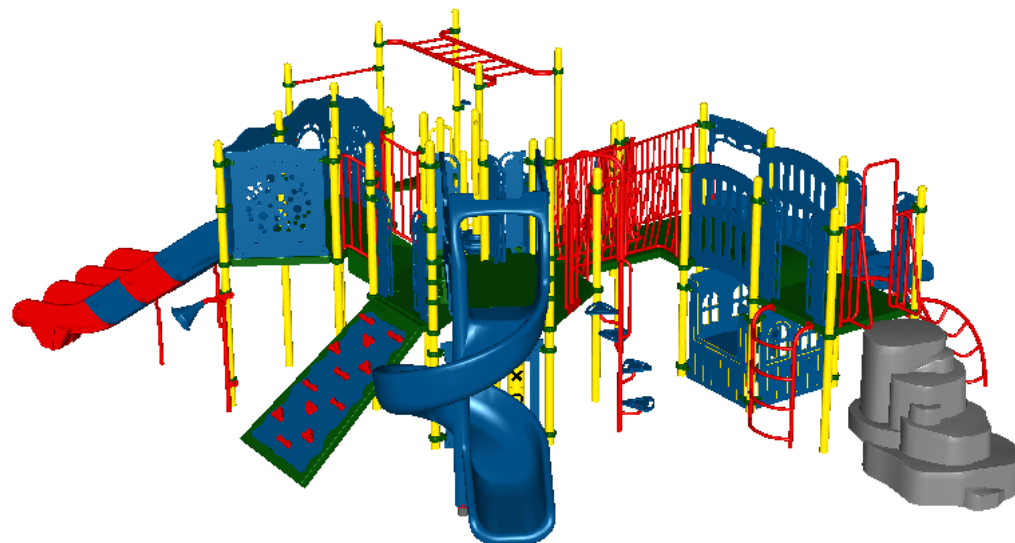

STRUCTURE#: R3567FE4C
PROJECT#: R3567FE4C
DATE: 4/21/2020 | DRAWN BY: Derick



Bill of Materials

R3567FE4C

Project# R3567FE4C

4/21/2020

Item	Description	Quantity
R3567FE4C		
HS-1004-R35	Collars	87
GG-8135	Dome Cap, R3.5	27
S-1009-R35-09ft	Post, 09ft R3.5	2
S-1010-R35-10ft	Post, 10ft R3.5	1
S-1011-R35-11ft	Post, 11ft R3.5	14
S-1012-R35-12ft	Post, 12ft R3.5	8
S-1013-R35-13ft	Post, 13ft R3.5	2
S-1101-R35	Square Deck	3
S-1102-R35	Tri-Deck	3
S-1103-R35	Hex Deck, Half (5 Post)	2
S-1110-R	Filler, 12in	2
S-1206-12R35	ADA Stairs, 12in Rise w/ Walls	1
S-1206-36R35	ADA Stairs, 36in Rise w/ Walls	1
S-1216-DLX	Climber, Deluxe Grip 42-48in	1
S-1219-4	Climber, Deep Rung Arch 42-48in	1
S-1233-1-HW	Climber, Disc 06-12in (w/ HW)	1
S-1233-3-MC	Climber, Disc 30-36in	1
S-1233-4-HW	Climber, Disc 42-48in (w/ HW)	1
S-1234-4R35	Climber, Spiral Step 42-48in	1
S-1282-4	Climber, Curved Rung Ladder 42-48in	1
S-1290-D2-R35	Climber, Boulder Stack 42-48in	1
S-1309-2-R35	Half Walls (Pair) R35	5
S-1309-R35-L	Half Walls (Single, Left)	1
S-1309-R35-R	Half Walls (Single, Right)	1
S-1316-R35	Twister Entry Panel	2



Bill of Materials (continued)

Item	Description	Quantity
S-1406-84R35	Traverse, Horizontal Ladder (7-Rung)	1
S-1501-R35	Bridge, Arch (42in)	1
S-1509-42R35	Bridge, Burma (42in)	1
S-1610-R35	Peek Panel	2
S-1616-R35G	Tic-Tac-Toe Panel	1
S-1639-R35	Clubhouse	1
S-1702-4R35	Slide, Wave 48in (Double)	1
S-1706-12R35	Slide, Spiral 72in (60in Deck Height, 12in Filler)	1
S-1710-5-SS	Slide, Twister 60in (S-S)	2
S-1910-R35	Talk Tube (Post Mounted, Left)	2
S-1930-R35	Chinning Bar	1
S-1937-R35	Crunch Handle	1
S-1962-R35	Playseat (Double Post)	1
HS-1100-2	Deck to Deck Hardware	3