

R3544827A**TOP VIEW**

ADA ACCESSIBILITY GUIDELINE - ADAAG CONFORMANCE

ELEVATED	ACCESSIBLE	RAMP ACCESSIBLE	GROUND	TYPES
4	4/2	0	3/1	2/1

R35

FOR KIDS

AGES
5-12**GENERAL NOTES:**

This conceptual plan is based on information provided prior to construction. Detailed site information, including the following, should be obtained, evaluated, and utilized in the final project design. Exact site dimensions, topography, existing utilities, soil conditions and drainage solutions.

WARNING: Accessible safety surfacing material is required beneath and around this equipment that has a critical height value (Fall Height) appropriate for the highest accessible part of this equipment. Refer to the CPSC'S Handbook For Public Playground Safety, Section 4: Surfacing.

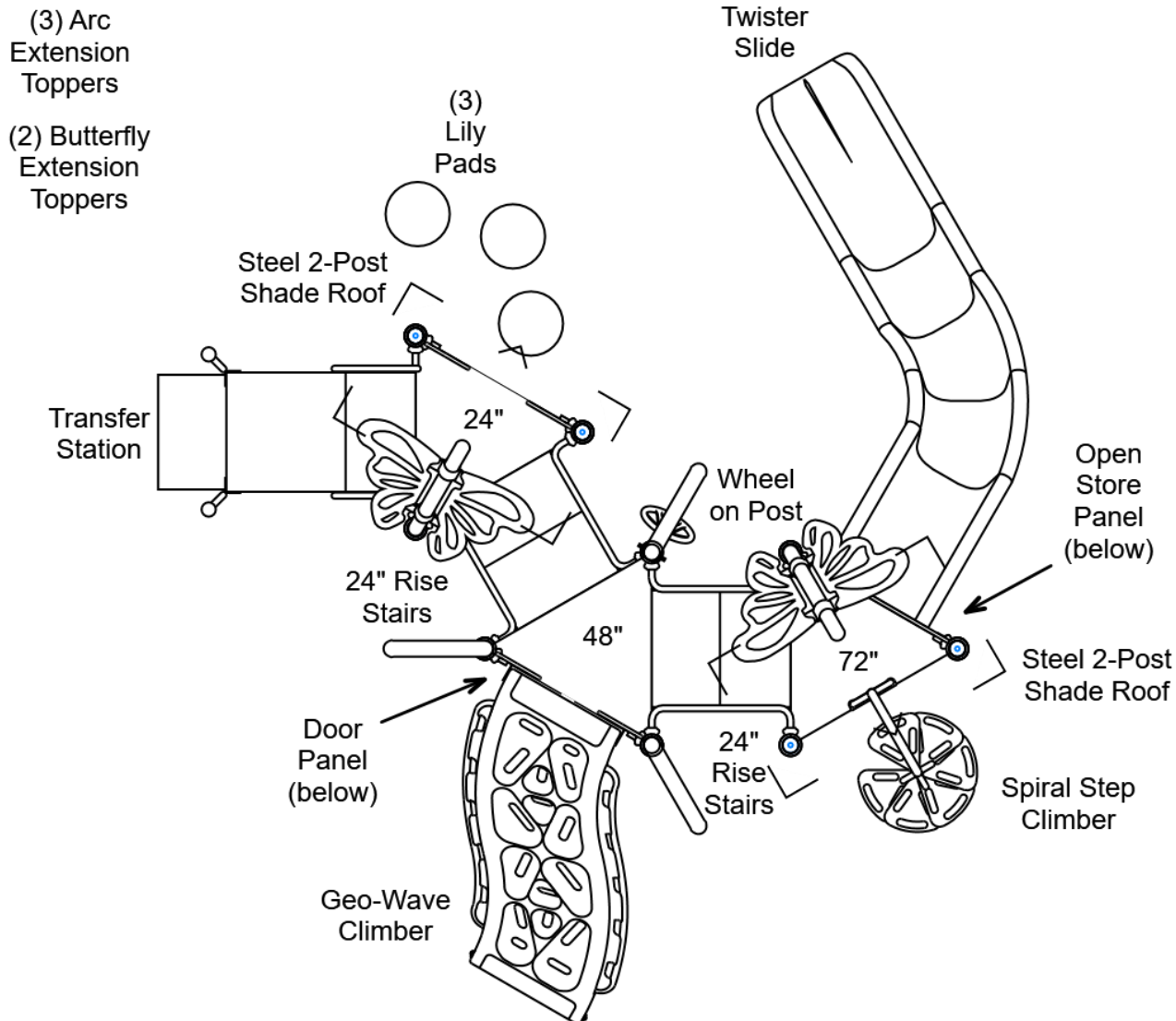

STRUCTURE#: R3544827A

PROJECT#: R3544827A

DATE: 11/23/2022

MIN. USE ZONE: 28' x 30'

PLAYCRAFT REP:

Playcraft Direct, Inc.

R3544827A
SITE PLAN

ADA ACCESSIBILITY GUIDELINE - ADAAG CONFORMANCE

ELEVATED	ACCESSIBLE	RAMP ACCESSIBLE	GROUND	TYPES
4	4/2	0	3/1	2/1

R35

FOR KIDS
AGES
5-12

GENERAL NOTES:

This Preliminary Site Plan is based on measurements that were provided in the initial planning phase. All dimensions must be verified prior to the submission of a purchase order. Playcraft Systems will not be held responsible for any discrepancies between actual dimensions and dimensions submitted in the planning phase.

The Minimum Use Zone for a play structure is based on the product design at the time of proposal. Components and structure designs may be subject to change which may affect dimensions. Therefore, before preparing the site, we strongly recommend obtaining final drawings from the factory (available after the order is placed and included in the Assembly Manual).

WARNING: Accessible safety surfacing material is required beneath and around this equipment that has a critical height value (Fall Height) appropriate for the highest accessible part of this equipment. Refer to the CPSC'S Handbook For Public Playground Safety, Section 4: Surfacing.

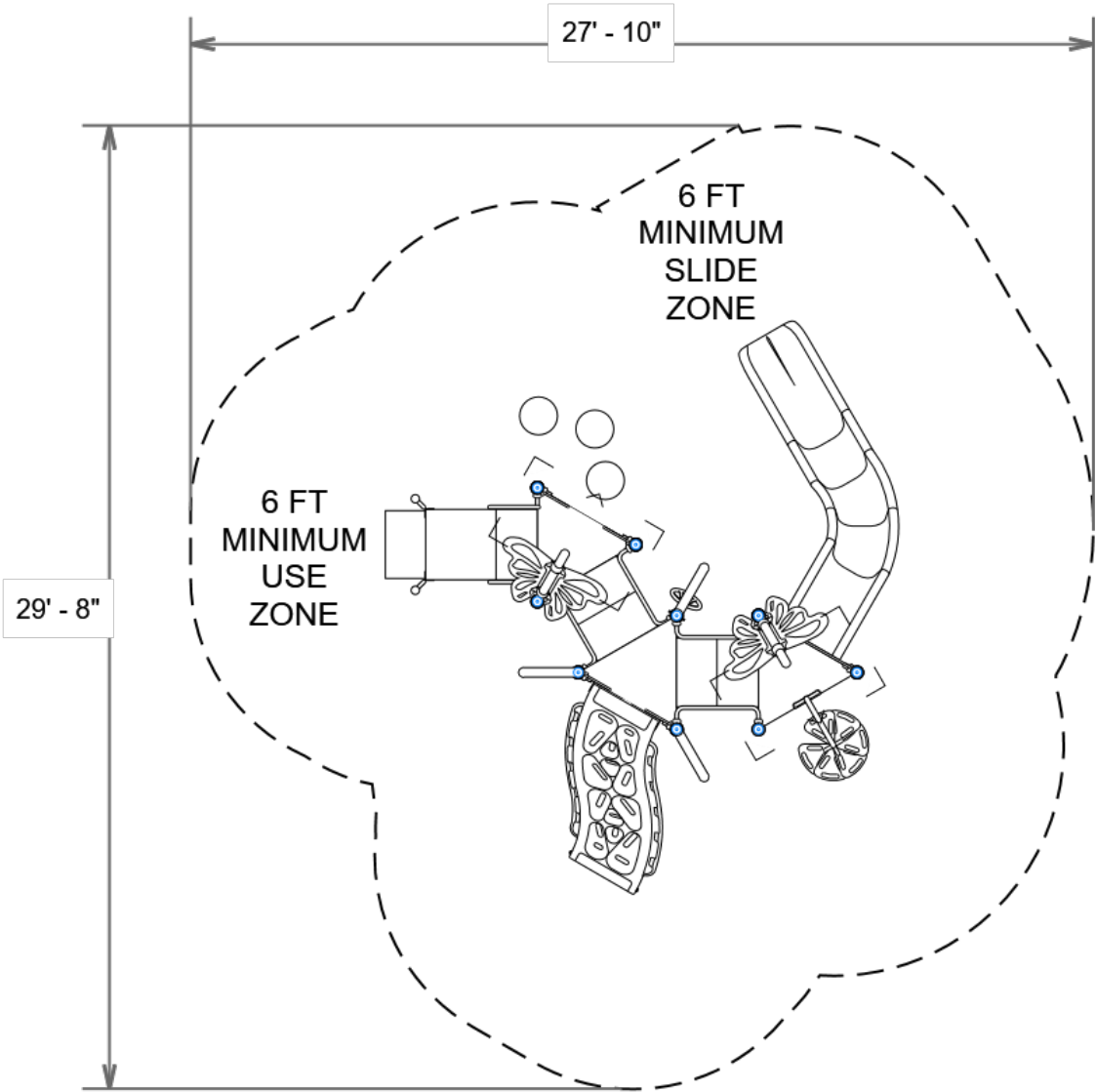

PROJECT#: R3544827A
DATE: 11/23/2022

MIN. USE ZONE: 28' x 30'

PLAYCRAFT REP:
Playcraft Direct, Inc.

R3544827A
SW VIEW

R35

FOR KIDS
AGES
5-12



STRUCTURE#: R3544827A
PROJECT#: R3544827A
DATE: 11/23/2022

R3544827A
NE VIEW

R35

FOR KIDS
AGES
5-12



STRUCTURE#: R3544827A
PROJECT#: R3544827A
DATE: 11/23/2022



Bill of Materials

R3544827A

Project# R3544827A

11/23/2022

Item	Description	Quantity
R3544827A		
HS-1004-R35	Collars	43
GG-8135	Dome Cap, R3.5	4
S-1010-R35-10ft	Post, 10ft R3.5	1
S-1012-R35-12ft	Post, 12ft R3.5	3
S-1013-R35-13ft	Post, 13ft R3.5	1
S-1014-R35-14ft	Post, 14ft R3.5	2
S-1018-R35-18ft	Post, 18ft R3.5	2
S-1102-R35	Tri-Deck	3
S-1206-24R35	ADA Stairs, 24in Rise w/ Walls	2
S-1209-12-R35	Transfer Station, 24in-C	1
S-1234-6R35	Climber, Spiral Step 66-72in	1
S-1249-DGH	Climber, Inc. Geo-Wave 42-48in (H, DTG, L)	1
S-1309-2-R35	Half Walls (Pair) R35	3
S-1316-R35	Twister Entry Panel	1
S-1414	Lily Pad Step 12-18in	2
S-1414-30	Lily Pad Step 24in	1
S-1645-R35G	Store Panel (Open)	1
S-1654-R35G	Door Panel	1
S-1710-6-LLS	Slide, Twister 72in (L2-S)	1
S-18012-R35	Metal Roof, 2-Post Shade	2
S-1812-R35	Driver Wheel (Post Mounted)	1
S-1850-R35	Arc Extension Topper	3
S-1851-R35CRV	Butterfly Extension Topper	2