

# NF5DB417A

## TOP VIEW

ADA ACCESSIBILITY GUIDELINE - ADAAG CONFORMANCE

ELEVATED	ACCESSIBLE	RAMP ACCESSIBLE	GROUND	TYPES
12	12/6	0	10/4	4/3

R5

FOR KIDS  
AGES  
5-12

### GENERAL NOTES:

This conceptual plan is based on information provided prior to construction. Detailed site information, including the following, should be obtained, evaluated, and utilized in the final project design. Exact site dimensions, topography, existing utilities, soil conditions and drainage solutions.

**WARNING:** Accessible safety surfacing material is required beneath and around this equipment that has a critical height value (Fall Height) appropriate for the highest accessible part of this equipment. Refer to the CPSC'S Handbook For Public Playground Safety, Section 4: Surfacing.

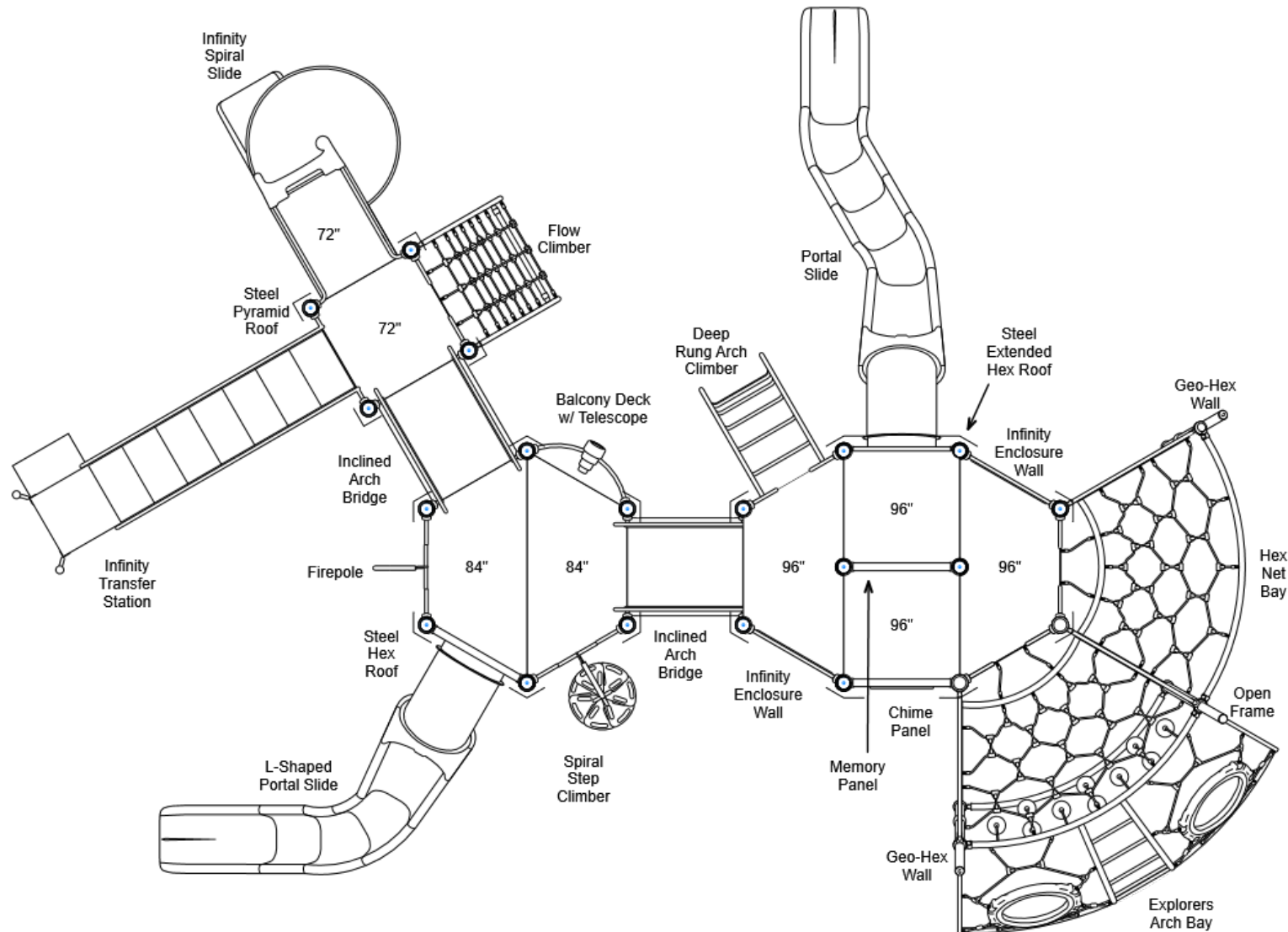

STRUCTURE#: NF5DB417A

PROJECT#: NF5DB417A

DATE: 6/30/2020 | DRAWN BY: Alyssa

MIN. USE ZONE: 53' x 44'

PLAYCRAFT REP:

**Playcraft Direct, Inc.**

NF5DB417A  
TOP VIEW

ADA ACCESSIBILITY GUIDELINE - ADAAG CONFORMANCE

ELEVATED	ACCESSIBLE	RAMP ACCESSIBLE	GROUND	TYPES
12	12/6	0	10/4	4/3

R5

FOR KIDS  
AGES  
5-12

GENERAL NOTES:

This conceptual plan is based on information provided prior to construction. Detailed site information, including the following, should be obtained, evaluated, and utilized in the final project design. Exact site dimensions, topography, existing utilities, soil conditions and drainage solutions.

WARNING: Accessible safety surfacing material is required beneath and around this equipment that has a critical height value (Fall Height) appropriate for the highest accessible part of this equipment. Refer to the CPSC'S Handbook For Public Playground Safety, Section 4: Surfacing.

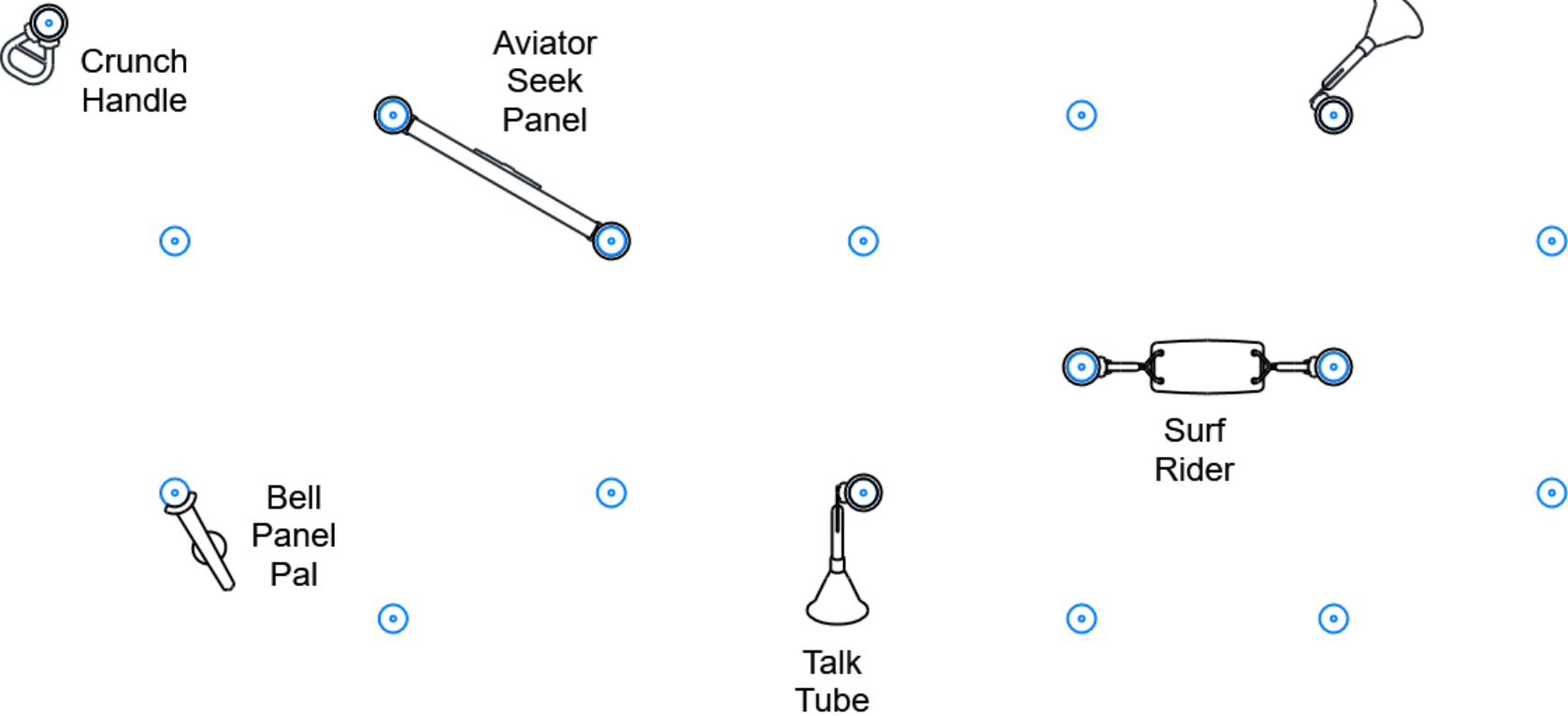

STRUCTURE#: NF5DB417A  
PROJECT#: NF5DB417A  
DATE: 6/30/2020 | DRAWN BY: Alyssa

MIN. USE ZONE: 53' x 44'

PLAYCRAFT REP:  
Playcraft Direct, Inc.

NF5DB417A  
SITE PLAN

ADA ACCESSIBILITY GUIDELINE - ADAAG CONFORMANCE

ELEVATED	ACCESSIBLE	RAMP ACCESSIBLE	GROUND	TYPES
12	12/6	0	10/4	4/3

R5

FOR KIDS  
AGES  
5-12

GENERAL NOTES:

This Preliminary Site Plan is based on measurements that were provided in the initial planning phase. All dimensions must be verified prior to the submission of a purchase order. Playcraft Systems will not be held responsible for any discrepancies between actual dimensions and dimensions submitted in the planning phase.

The Minimum Use Zone for a play structure is based on the product design at the time of proposal. Components and structure designs may be subject to change which may affect dimensions. Therefore, before preparing the site, we strongly recommend obtaining final drawings from the factory (available after the order is placed and included in the Assembly Manual).

WARNING: Accessible safety surfacing material is required beneath and around this equipment that has a critical height value (Fall Height) appropriate for the highest accessible part of this equipment. Refer to the CPSC'S Handbook For Public Playground Safety, Section 4: Surfacing.

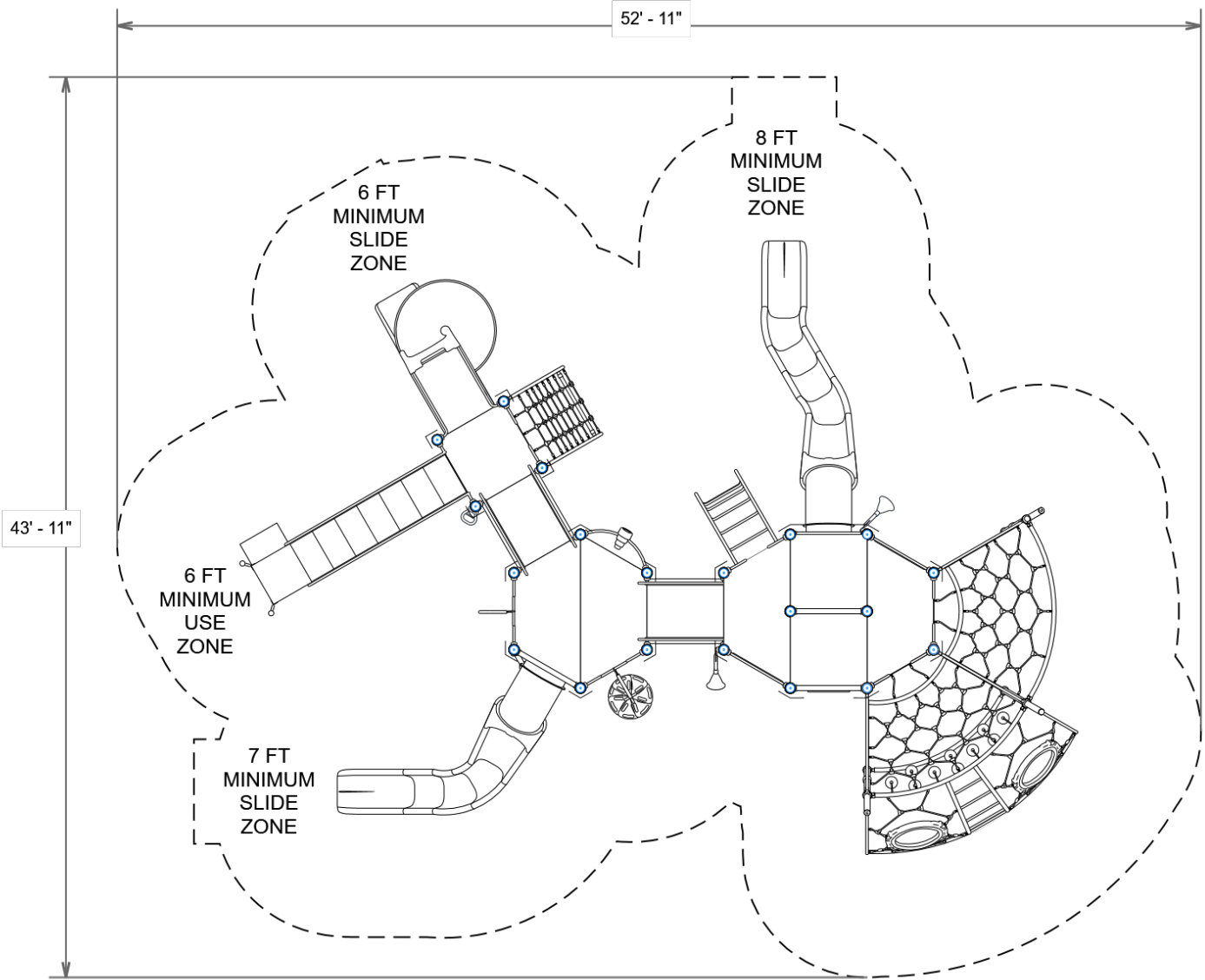

PROJECT#: NF5DB417A  
DATE: 6/30/2020 | DRAWN BY: Alyssa

MIN. USE ZONE: 53' x 44'

PLAYCRAFT REP:  
Playcraft Direct, Inc.

**NF5DB417A**  
**SW VIEW**

R5

FOR KIDS  
AGES  
5-12



STRUCTURE#: NF5DB417A

PROJECT#: NF5DB417A

DATE: 6/30/2020 | DRAWN BY: Alyssa

**NF5DB417A**  
**NE VIEW**

R5

FOR KIDS  
AGES  
5-12



STRUCTURE#: NF5DB417A  
PROJECT#: NF5DB417A  
DATE: 6/30/2020 | DRAWN BY: Alyssa



## Bill of Materials

NF5DB417A

Project# NF5DB417A

6/30/2020

Item	Description	Quantity
NF5DB417A		
HS-1004-R	Collars	80
GF-7002	Dome Cap, R5	2
S-1015-R5-15ft	Post, 15ft R5	2
S-1017-R5-17ft	Post, 17ft R5	10
S-1018-R5-18ft	Post, 18ft R5	8
S-1101-R5	Square Deck	3
S-1103-R5	Hex Deck, Half (5 Post)	2
S-1106-R5	Hex Deck, Half (4 Post)	2
S-1109-R5-T	Balcony Deck w/ Telescope	1
S-1209-60IW	Infinity Transfer Station, 72in-L	1
S-1213-7R	Climber, Firepole 78-84in	1
S-1219-8	Climber, Deep Rung Arch 90-96in	1
S-1234-7R	Climber, Spiral Step 78-84in	1
S-1261-R5F	Climber, Flow	1
S-1301-IW	Wall, Infinity (Standard)	2
S-1309-2-R5	Half Walls (Pair) R5	1
S-1309-IW-R5	Infinity Half Walls (Pair)	4
S-1310-IW-R5	Infinity Transition Wall	2
S-1514-45R5	Bridge, Inclined Arch (45in)	2
S-1604-R5	Chime Panel	1
S-1608-R5	Memory Panel	1
S-1618-R5AVG	Seek Panel (Aviator)	1
S-1661-R5	Panel Pal, Bell	1
S-1706-6IR5	Slide, Infinity Spiral 72in	1
S-1709-7L-RRS	Slide, Portal 84in (R-R-S, Right)	1



## Bill of Materials (continued)

Item	Description	Quantity
S-1709-8S-LSSR	Slide, Portal 96in (L-S-S-R, Left)	1
S-1803-R5STL	Metal Roof, Hex	1
S-1806-R5STL	Metal Roof, Hex (Extended)	1
S-1807-R5STL	Metal Roof, Pyramid	1
S-1910-R5	Talk Tube (Post Mounted, Right)	1
S-1910-R5	Talk Tube (Post Mounted, Left)	1
S-1937-R5	Crunch Handle	1
S-1948-R5	Surf Rider	1
S-5101	Open Frame	1
S-5103	Geo-Hex Wall	2
S-5201-DL	Hex Net Bay (Deck)	1
S-5206-DL	Explorers Arch Bay (Deck)	1
HS-1100-2	Deck to Deck Hardware	7